

# MANUAL RE-PAINT AXIS P551X/-E

## Network Dome Cameras



# 1 Table of Contents

<b>1</b>	<b><i>Table of Contents</i></b>	<b>2</b>
<b>2</b>	<b><i>Introduction</i></b>	<b>3</b>
<b>3</b>	<b><i>Influence on Warranty and Product performance</i></b>	<b>3</b>
<b>3.1</b>	<b>Product Warranty</b>	<b>3</b>
<b>3.2</b>	<b>Product Performance</b>	<b>3</b>
<b>4</b>	<b><i>Tools Required</i></b>	<b>3</b>
<b>5</b>	<b><i>Repaint instruction for P551X-E series</i></b>	<b>4</b>
<b>5.1</b>	<b>Repainting of the Chassis</b>	<b>4</b>
5.1.1	Removal of weather shield	4
5.1.2	Removal of the Dome Module Ass	5
5.1.3	Removal of the Push-pull Connector Housing	6
5.1.4	Removal of the Chassis Hook	7
5.1.5	Removal of the Screws Bayonett	7
5.1.6	Create a masking box for the Chassis and position the unit	8
5.1.7	Masking of the Chassis	9
<b>5.2</b>	<b>Repainting of the Dome Module Ass</b>	<b>10</b>
5.2.1	Removal of the Dome Module Bracket & the Dome with sealing	10
5.2.2	Removal of the dome sealing	12
5.2.3	Mask Gore filters.	12
<b>6</b>	<b><i>Repaint instruction for P551X series</i></b>	<b>13</b>
<b>6.1</b>	<b>Repainting of the Chassis</b>	<b>13</b>
6.1.1	Removal of the Chassis Hook and Lid	14
6.1.2	Removal of the Screws Bayonett	14
6.1.3	Create a masking box for the Chassis and position the unit	16
6.1.4	Masking of the Chassis	16
<b>6.2</b>	<b>Repainting of the Dome Module Ass</b>	<b>18</b>
6.2.1	Removal of the Dome Module Bracket & the Dome with sealing	18
6.2.2	Removal of the dome sealing	19
<b>7</b>	<b><i>APPENDIX: Assembly drawings and overview of products</i></b>	<b>20</b>
<b>7.1</b>	<b>Assembly drawings of P551X-E series</b>	<b>20</b>
7.1.1	Main Assembly	20
7.1.2	Weather Shield Assembly	21
7.1.3	Dome Module Assembly	21
<b>7.2</b>	<b>Assembly drawings of P551X series</b>	<b>22</b>
7.2.1	Main Assembly	22
7.2.2	Dome Module Assembly	22
<b>8</b>	<b><i>Revision History</i></b>	<b>23</b>

## 2 Introduction

This document describes the way to operate when Re-painting a P551X / -E Network Dome Camera. Any attempt to carry out a Re-painting operation on the camera, should only be made after reading this document thoroughly.

To prevent damage to sensitive components, proper ESD protection must be carried out while handling of the parts is only allowed in dust free environment.

## 3 Influence on Warranty and Product performance

### 3.1 Product Warranty

Any aftermarket modifications, which are not approved by Axis Communications AB, made on Axis Network Dome cameras will void the Product warranty. Therefore, please note that any deviation from the re-paint instructions described in this document will void the Product warranty.

### 3.2 Product Performance

Axis Communications AB will only guarantee the product specifications and performance of the camera in its original form.

## 4 Tools Required

- Torx Screwdriver, (T8, T10, T20)
- Screwdriver Flat > 6 mm width
- Carton box min 190x190x140 mm
- Knife for cutting in carton

## 5 Repaint instruction for P551X-E series

To repaint the P551X-E series Dome Network Camera, the camera will have to be divided into three parts: Weather Shield, Chassis and Dome Module. Each part is then stripped from components or masked to enable the repainting. Before the painting, crucial parts of the camera are masked to ensure the fit and function when the camera is reassembled again.

To prevent damage to sensitive components, proper ESD protection must be carried out while handling of the parts is only allowed in dust free environment.

Please follow the workflow as described below. Any deviations from the proposed instruction will void the Product warranty.

### 5.1 Repainting of the Chassis

Please note that the original surface finish of the chassis is Powder coating.

#### 5.1.1 Removal of weather shield

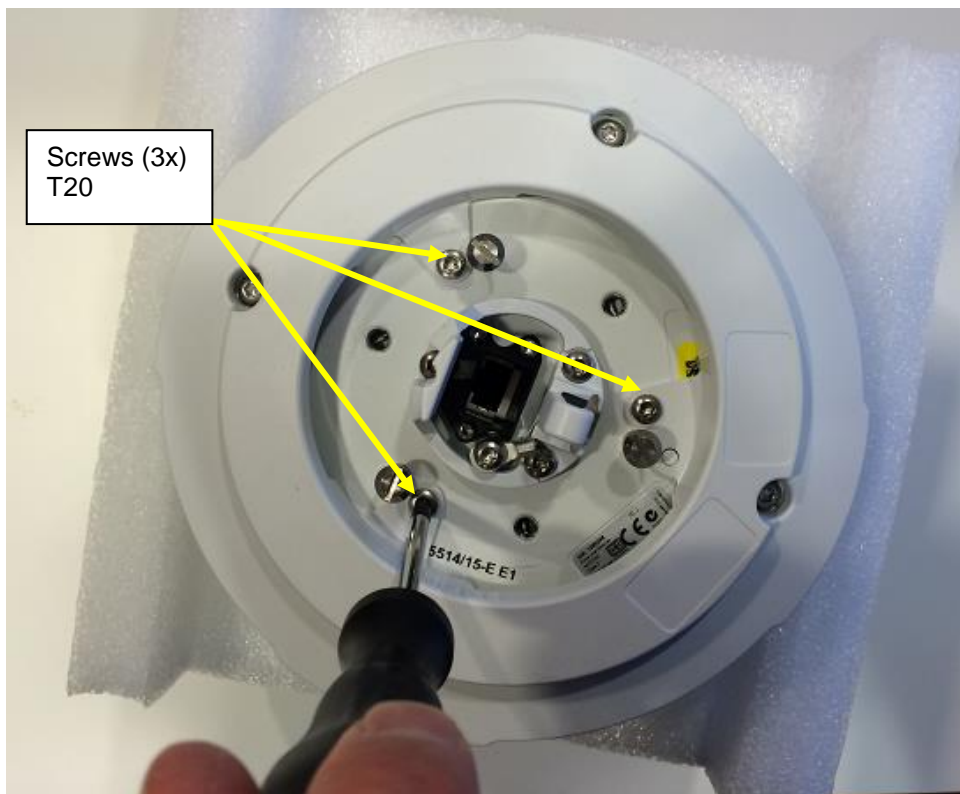

Tool: Screwdriver Torx20  
Torque (when refitting): 2 Nm

Put the weather shield to the side for painting.

## 5.1.2 Removal of the Dome Module Ass

### Step 1

Remove the four Antiloss screws that hold the Dome module ass. Remove the Dome module ass.

Tool: Screwdriver Torx20

Torque (when refitting): 2 Nm

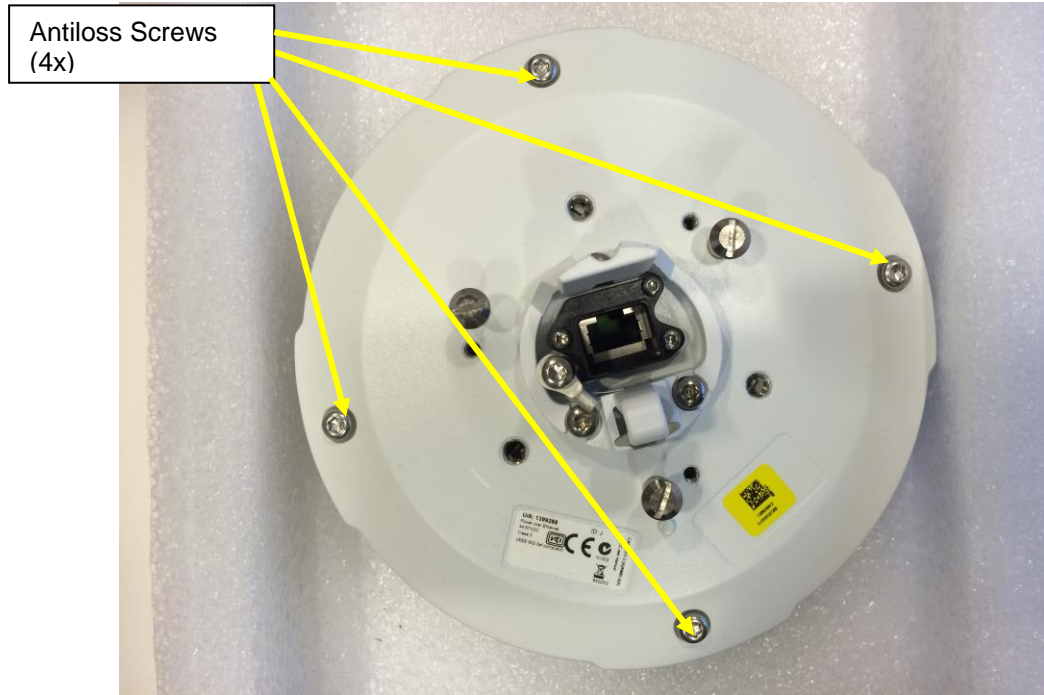

**When refitting, Please note:**

- 1) The Max tightening torque must not exceed **2 Nm**

### 5.1.3 Removal of the Push-pull Connector Housing

#### Step 1

Remove the two screws that hold the Push-pull connector housing and remove the housing.

Tool: Screwdriver Torx8

Torque (when refitting): 0,3Nm

Push Pull Housing

Screws (3x)

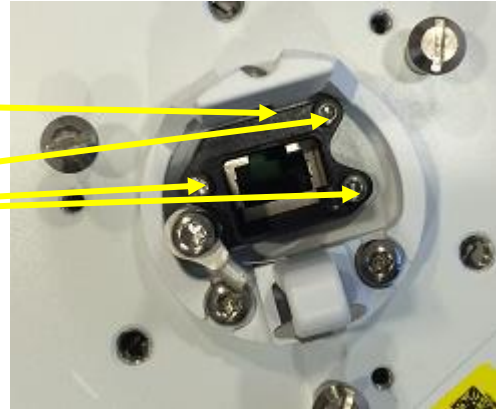

## 5.1.4 Removal of the Chassis Hook

### Step 1

Remove the three screws that hold the Chassis hook.

Tool: Screwdriver Torx20

Torque (when refitting): 2,4Nm

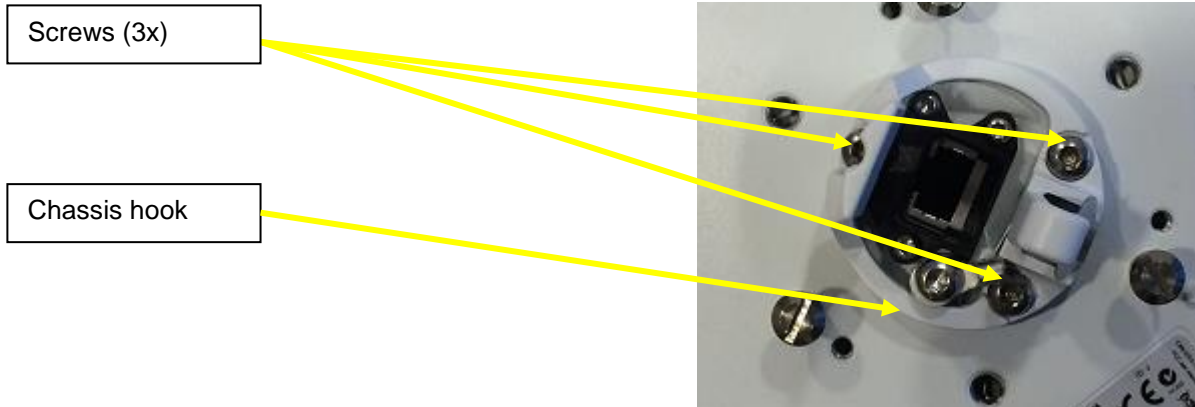

### When refitting, Please note:

Please note the maximum torque of 2,4 Nm.

## 5.1.5 Removal of the Screws Bayonett

Remove the three Bayonett screws.

Tool: Screwdriver, Minus Bit

Torque (when refitting): 1,8Nm

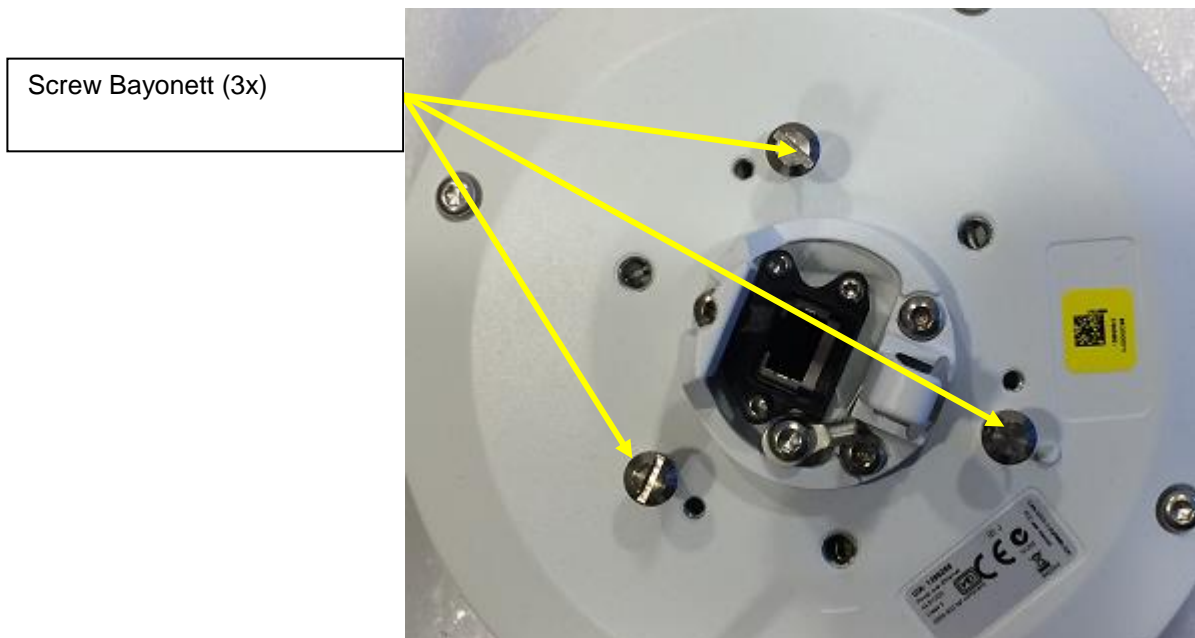

### When refitting, Please note:

Please note the maximum torque of 1,8Nm.

### 5.1.6 Create a masking box for the Chassis and position the unit

Cut a circular hole with diameter 147 mm in the middle of the 190x190 mm side of the box.

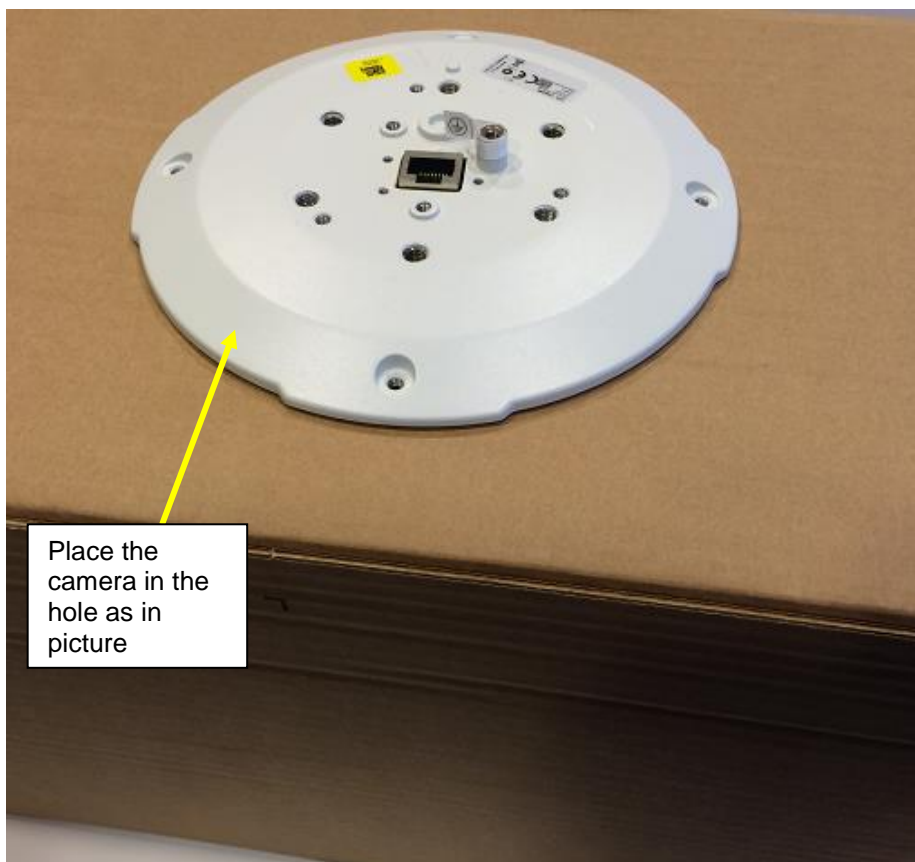
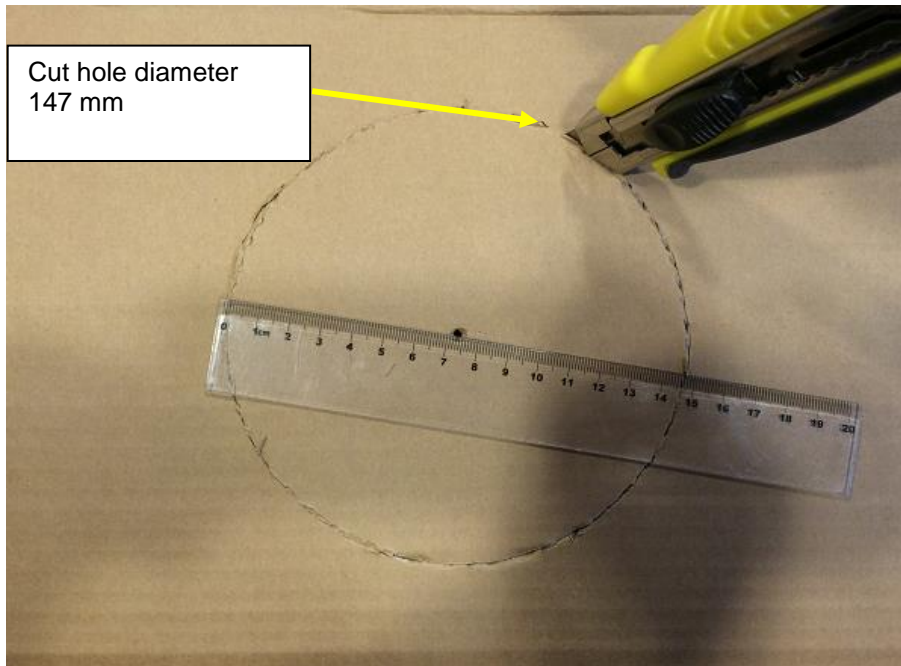

It is of highest importance that no paint particles are escaping inside the camera!



### 5.1.7 Masking of the Chassis

In order to maintain the fit and function of the camera, some parts of it need to be masked before painting. This applies to parts like threaded screw holes, assembly surfaces as well as electrical connectors.

#### Step 1

Mask **all** the 19 threaded screwholes and the connector together with the corresponding slot on the top surface of the chassis.

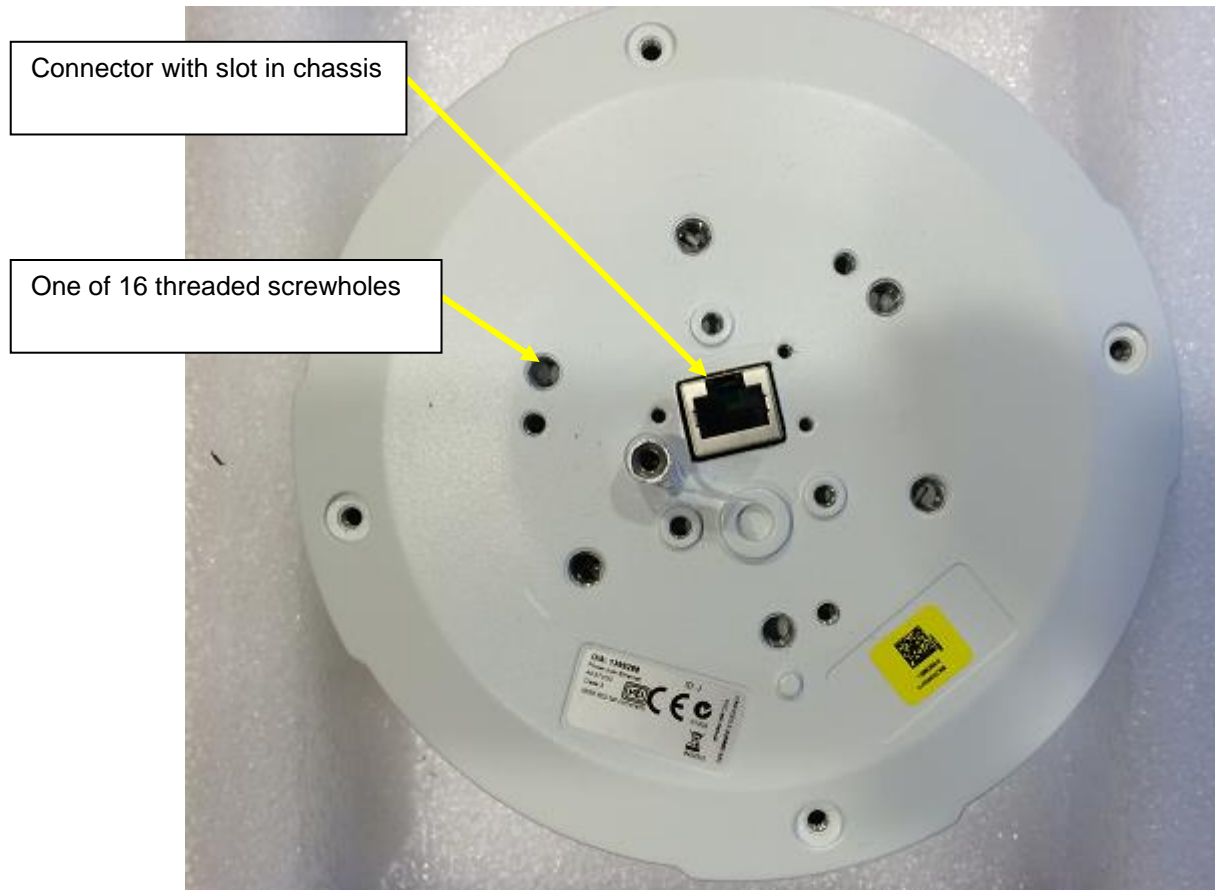

One easy way, to mask all above mentioned features, is to attach a mask with a diameter of 90mm in one piece all over them, as shown in the picture below.

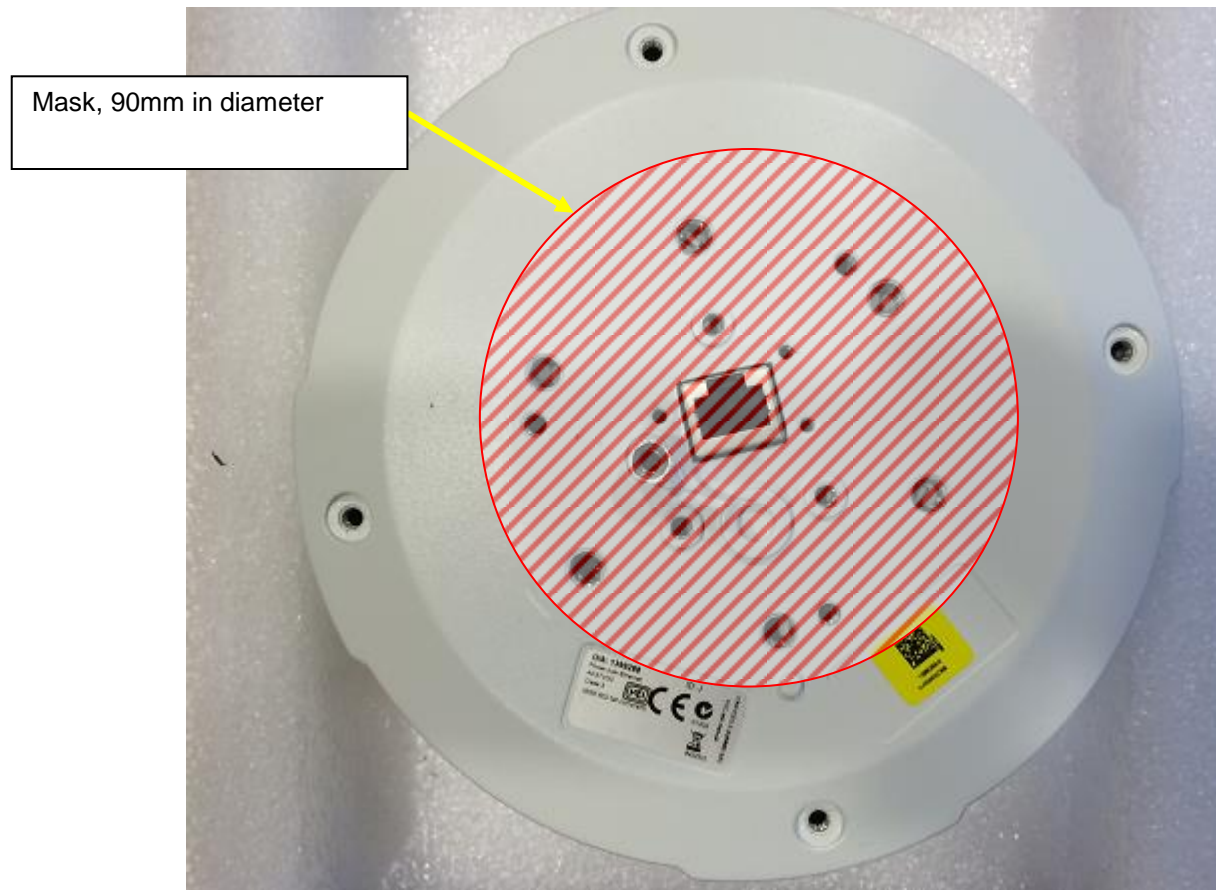

## 5.2 Repainting of the Dome Module Ass

When repainting the Dome Module ass, the Cover is the part to repaint. Please follow each step described below. As mentioned earlier, the proper masking before painting is of highest importance in order to ensure good fit and function when reassembling the camera again. Please note that any deviation from the steps described below will void the product warranty. Please note that the original surface finish of the Dome cover ring is PC+ASA. Please use compatible paint.

### 5.2.1 Removal of the Dome Module Bracket & the Dome with sealing

Remove the eight screws that hold the Dome module bracket. Remove the Dome Module bracket together with the Dome with sealing.

Tool: Screwdriver Torx T10

Torque (when refitting): 0,25 Nm

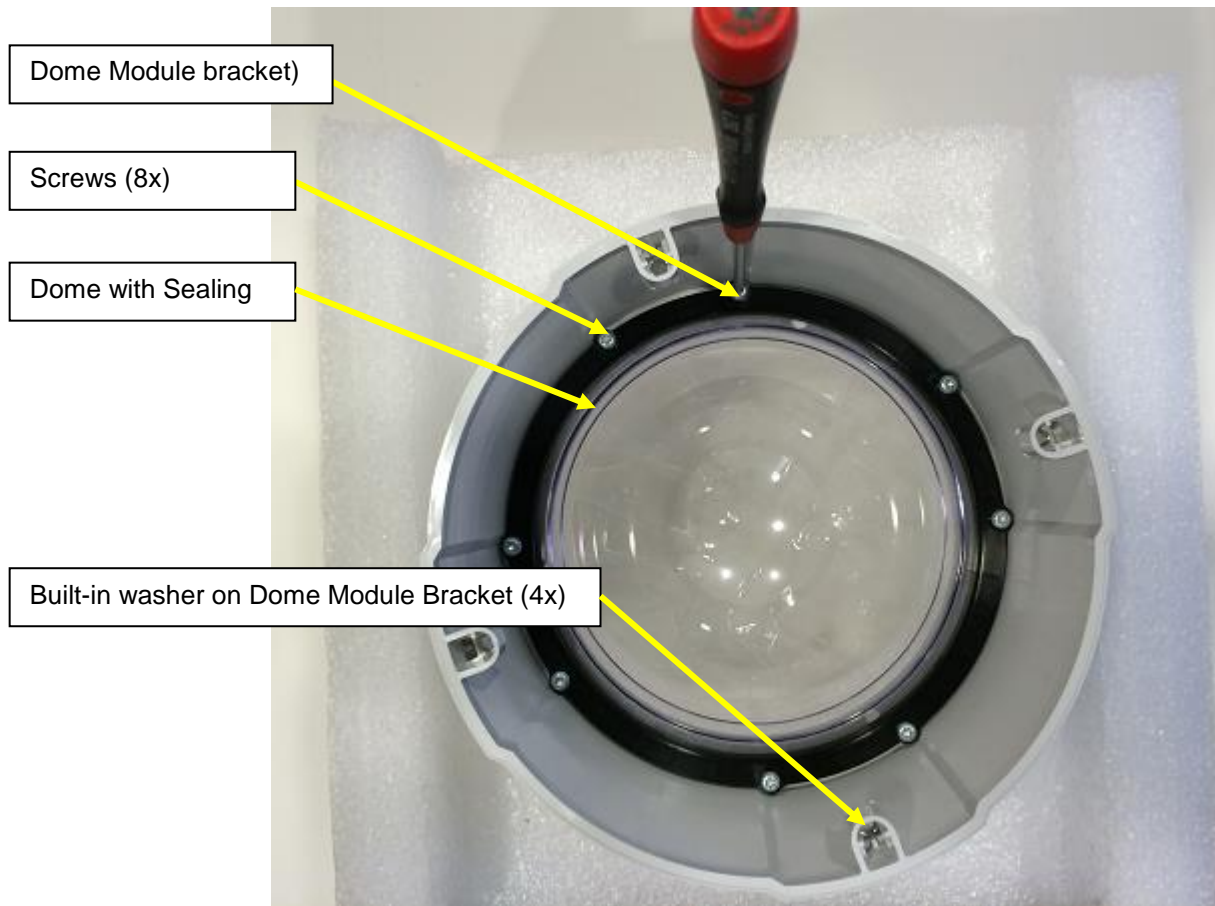

**When refitting, Please note:**

- 1) Please note the maximum torque of 0,25Nm.
- 2) The screws are self threading in the plastic. It is important that the screws thread enter the plastic in the same position as in the original mounting. Turn the screws anti-clockwise to get the feeling where the original thread start.

### 5.2.2 Removal of the dome sealing

The dome sealing ring is easily removed by hand from the cover.

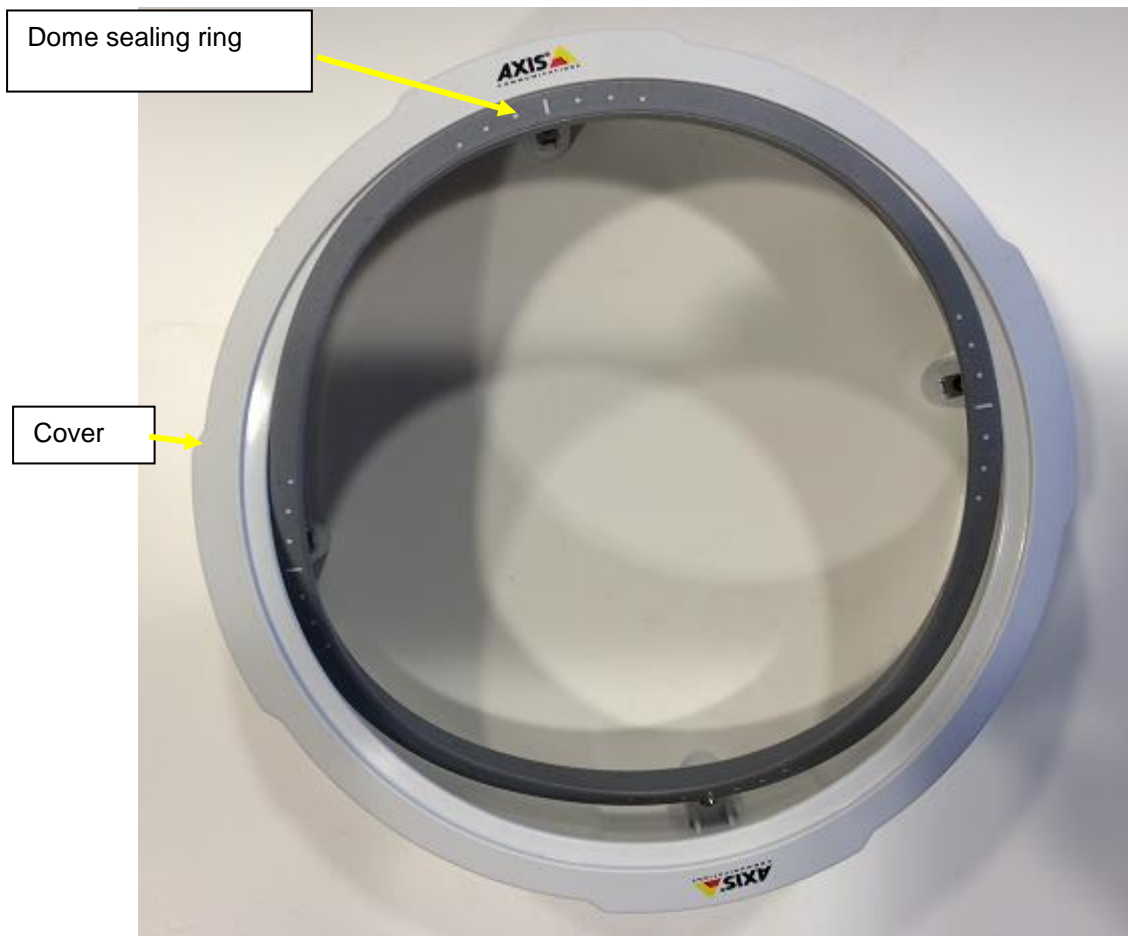

### 5.2.3 Mask Gore filters.

There are four holes at the flange of the Cover that must be masked. The ventilation will be destroyed if the holes are not properly masked.

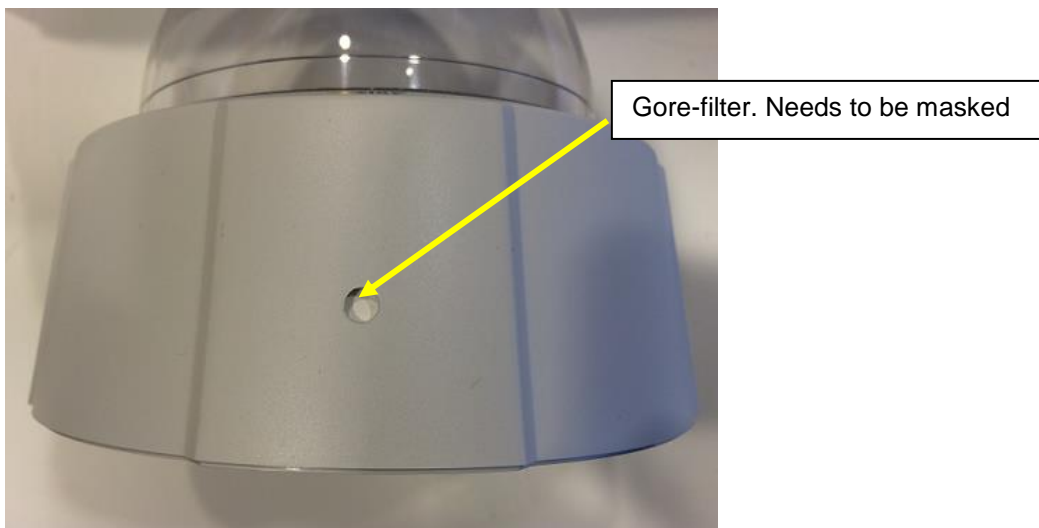

## 6 Repaint instruction for P551X series

To repaint the P551X series Dome Network Camera, the camera will have to be divided into three parts: Chassis, Ass Lid and Dome Module. Please refer to [chapter 7.2](#) for an assembly overview. Each part is then stripped from components to enable the repainting. Before the painting, crucial parts of the camera are masked to ensure the fit and function when the camera is reassembled again.

To prevent damage to sensitive components, proper ESD protection must be carried out while handling of the parts is only allowed in dust free environment.

Please follow the workflow as described below. Any deviations from the proposed instruction will void the Product warranty.

### 6.1 Repainting of the Chassis

Please note that the original surface finish of the Chassis is Powder coating.

#### Step 1 (Removal of Dome Module Ass)

Remove the four screws (M4x17 ANTILOSS) that hold the Dome module ass and remove the Dome module ass. See picture below.

Tool: Screwdriver Torx20

Torque (when refitting): 4Nm

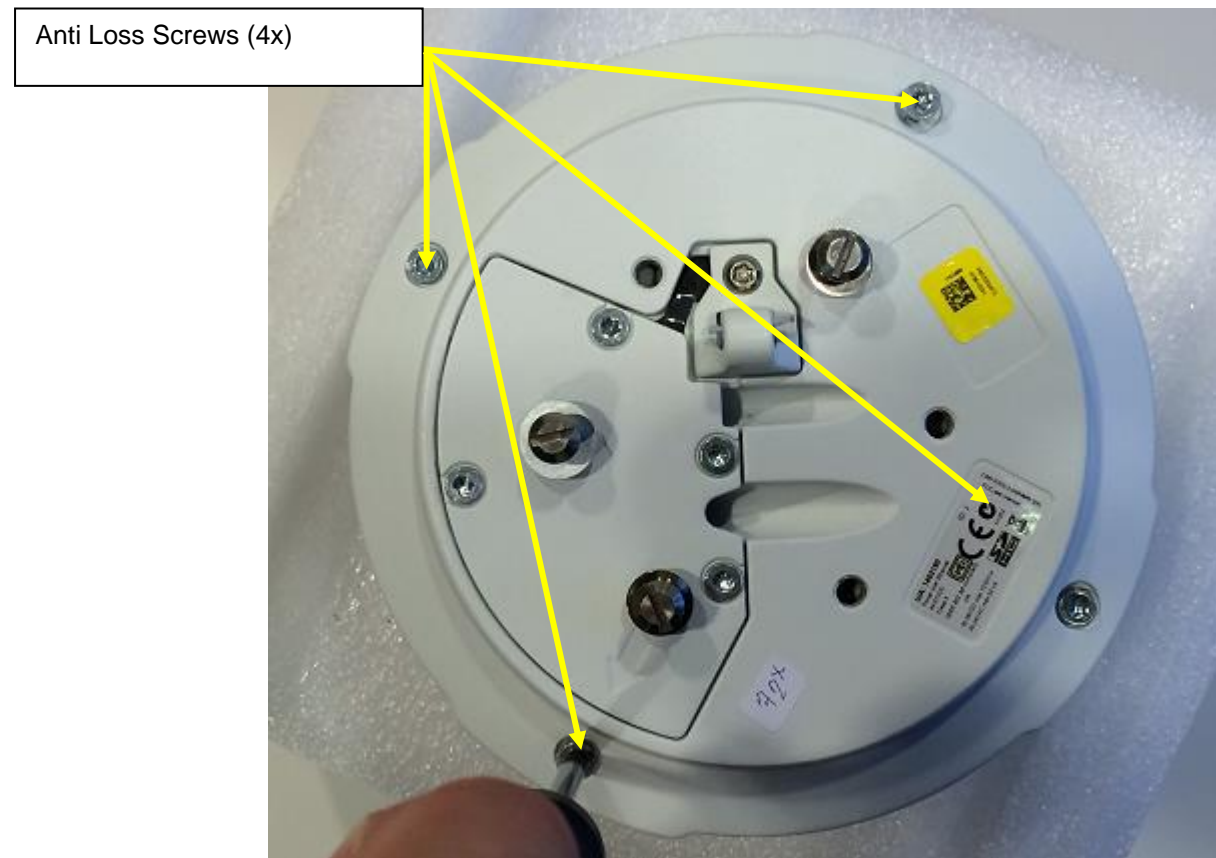

#### **When refitting, Please note:**

Please note the maximum torque of 4Nm.

## 6.1.1 Removal of the Chassis Hook and Lid

### Step 1

Remove the three screws that hold the Chassis hook.

Tool: Screwdriver Torx20

Torque (when refitting): 2,4Nm

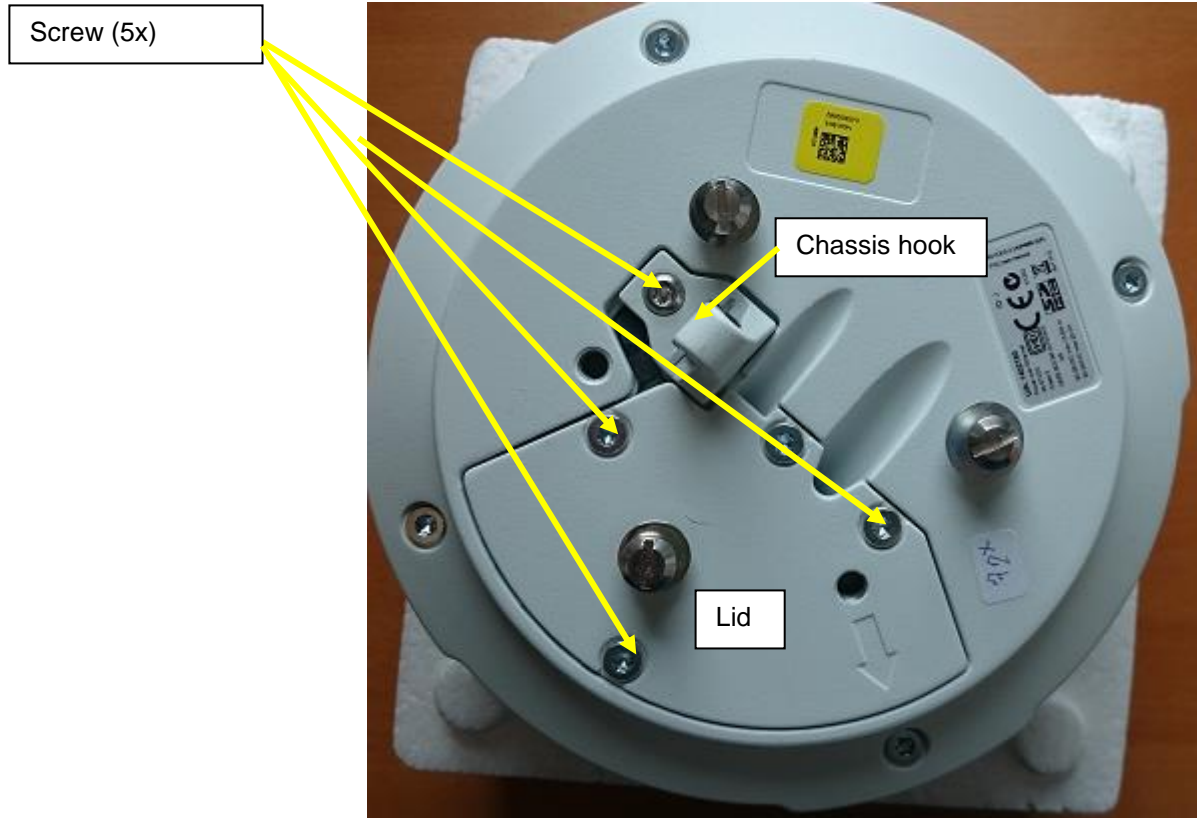

### **When refitting, Please note:**

Please note the maximum torque of 2,4 Nm.

## 6.1.2 Removal of the Screws Bayonett

Remove the three Bayonett screws.

Tool: Screwdriver, Minus Bit

Torque (when refitting): 1,8Nm

Screw Bayonett (3x)

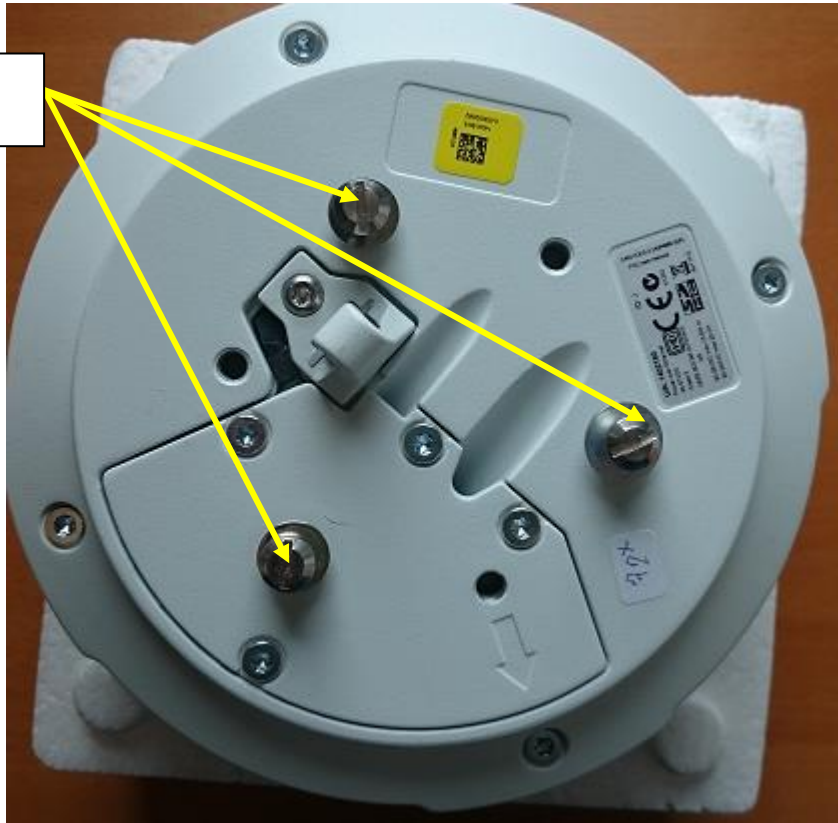

**When refitting, Please note:**

Please note the maximum torque of 1,8Nm.

### 6.1.3 Create a masking box for the Chassis and position the unit

Cut a circular hole with diameter 147 mm in the middle of the 190x190 mm side of the box.

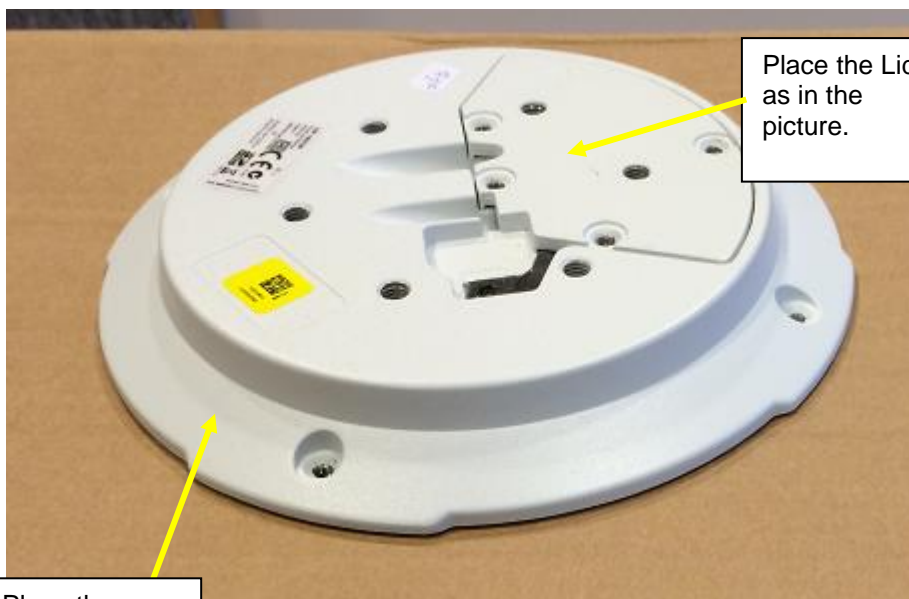
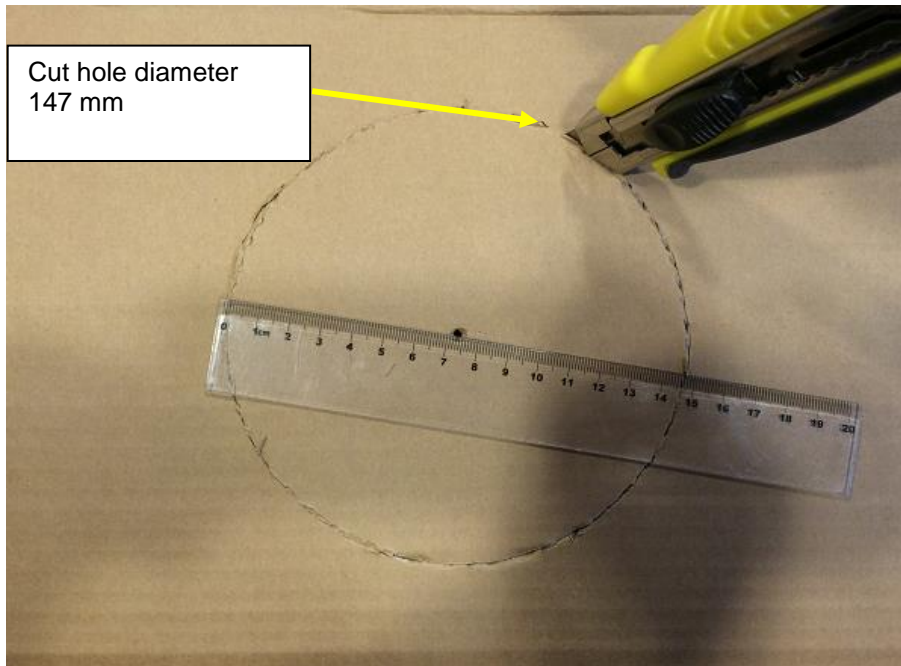

Place the camera in the hole as in picture

importance that no paint particles are escaping inside the camera!

### 6.1.4 Masking of the Chassis

In order to maintain the fit and function of the camera, some parts of it need to be masked before painting. This applies to parts like threaded screw holes, assembly surfaces as well as electrical connectors.



**Step 1**

Mask all the 16 threaded screwholes and the connector together with the corresponding slot on the top surface of the chassis.

One of 16 threaded screwholes



One easy way, to mask all above mentioned features, is to attach a mask with a diameter of 90mm in one piece all over them, as shown in the picture below.

Mask, 90mm in diameter

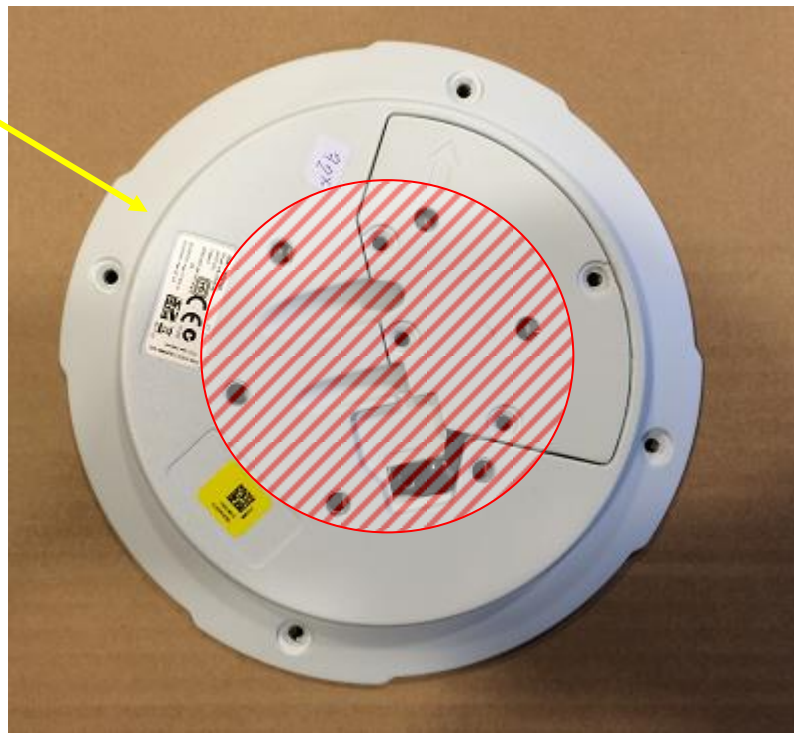

## 6.2 Repainting of the Dome Module Ass

When repainting the Dome Module ass, the Cover is the part to repaint. Please follow each step described below. As mentioned earlier, the proper masking before painting is of highest importance in order to ensure good fit and function when reassembling the camera again. Please note that any deviation from the steps described below will void the product warranty.  
Please note that the original surface finish of the Dome cover ring is PC+ASA. Please use compatible paint.

### 6.2.1 Removal of the Dome Module Bracket & the Dome with sealing

Remove the eight screws that hold the Dome module bracket. Remove the Dome Module bracket together with the Dome with sealing.

Tool: Screwdriver Torx T10

Torque (when refitting): 0,25 Nm

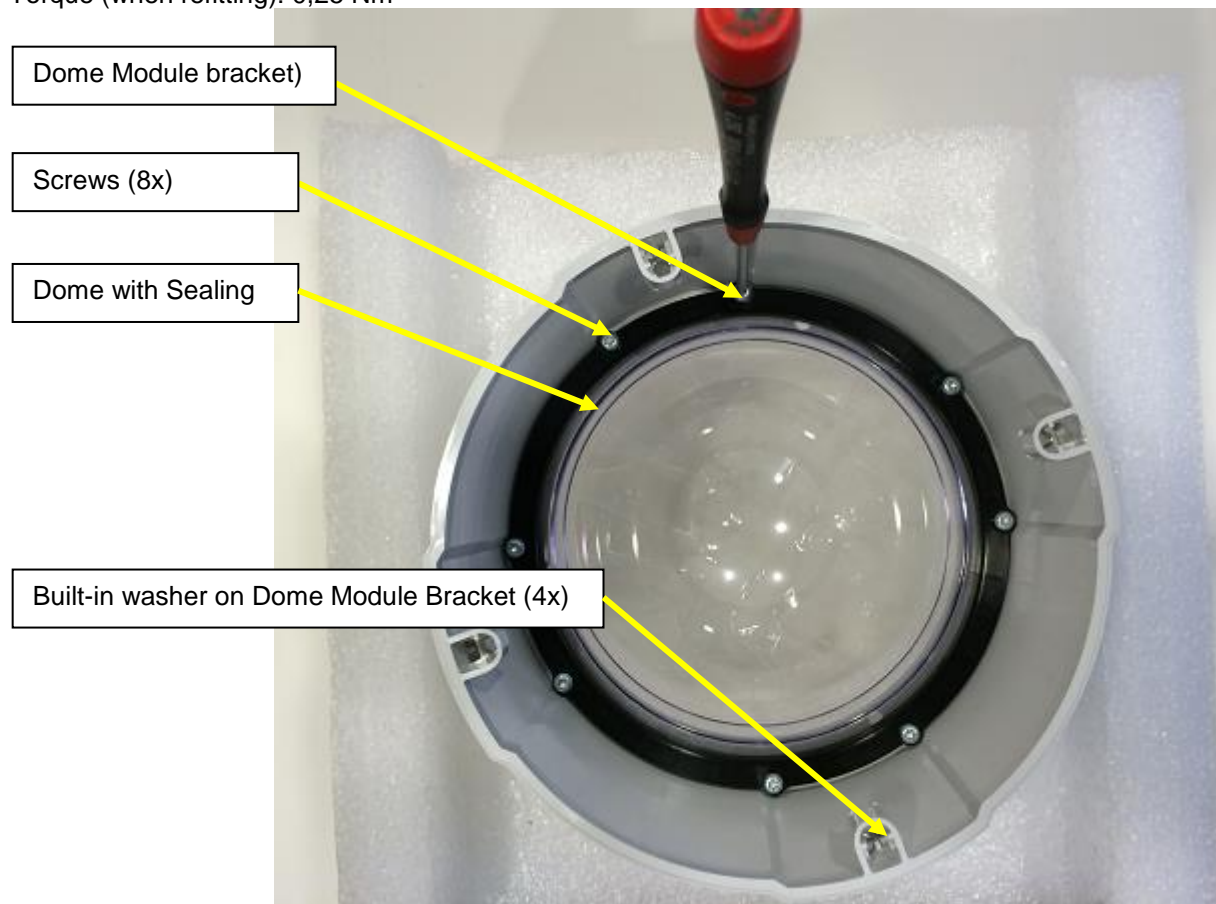

#### **When refitting, Please note:**

- 1) Please note the maximum torque of 0,25Nm.
- 2) The screws are self threading in the plastic. It is important that the screws thread enter the plastic in the same position as in the original mounting. Turn the screws anti-clockwise to get the feeling where the original thread start.

## 6.2.2 Removal of the dome sealing

The dome sealing ring is easily removed by hand from the cover.

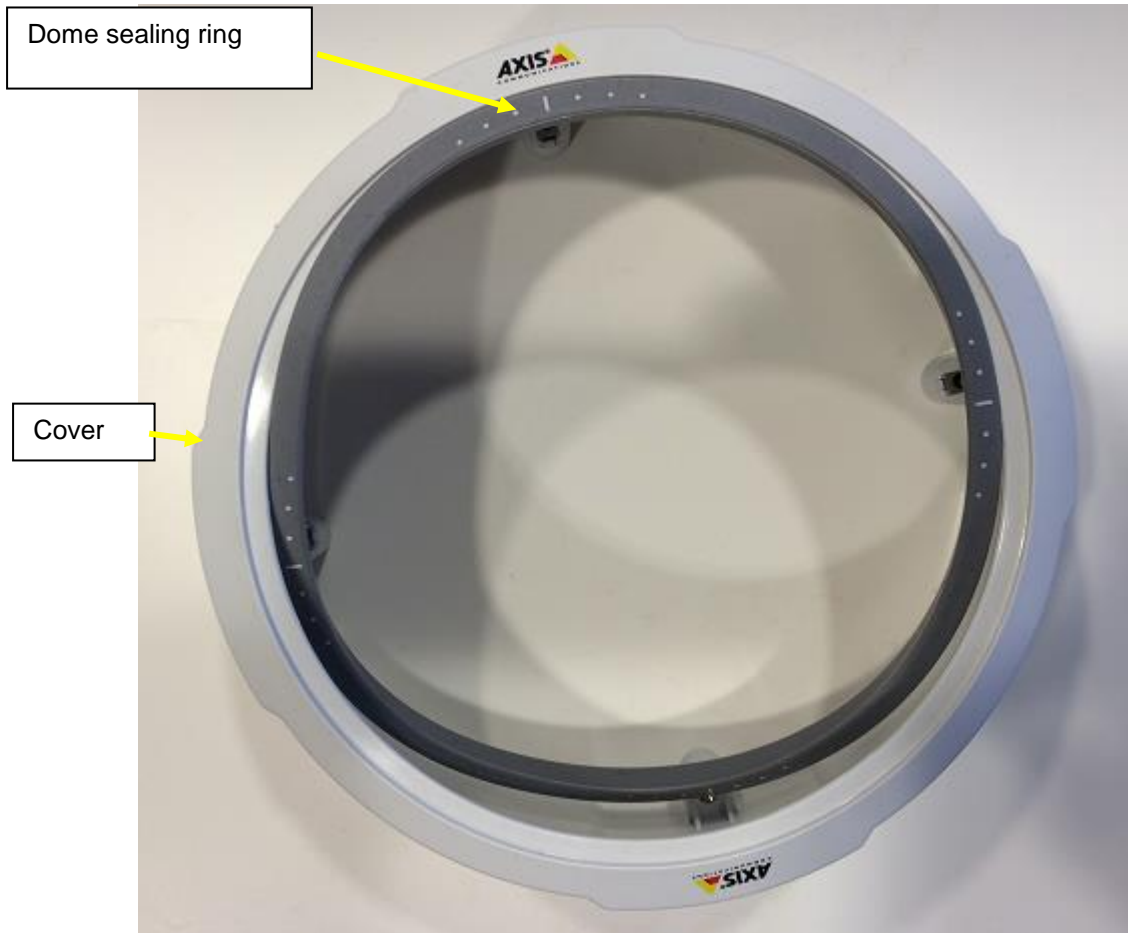

## 7 APPENDIX: Assembly drawings and overview of products

### 7.1 Assembly drawings of P551X-E series

#### 7.1.1 Main Assembly

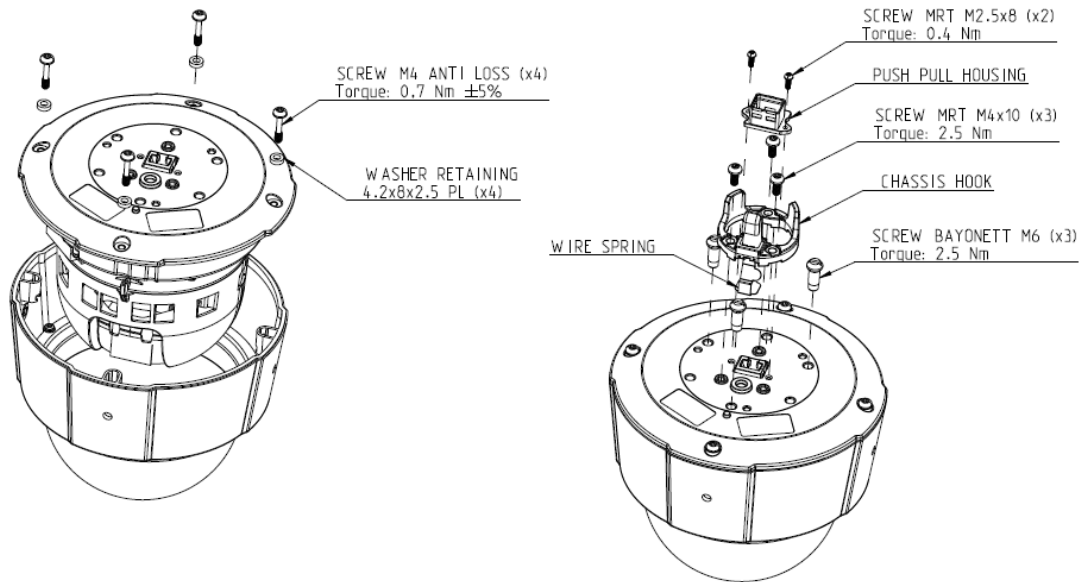

### 7.1.2 Weather Shield Assembly

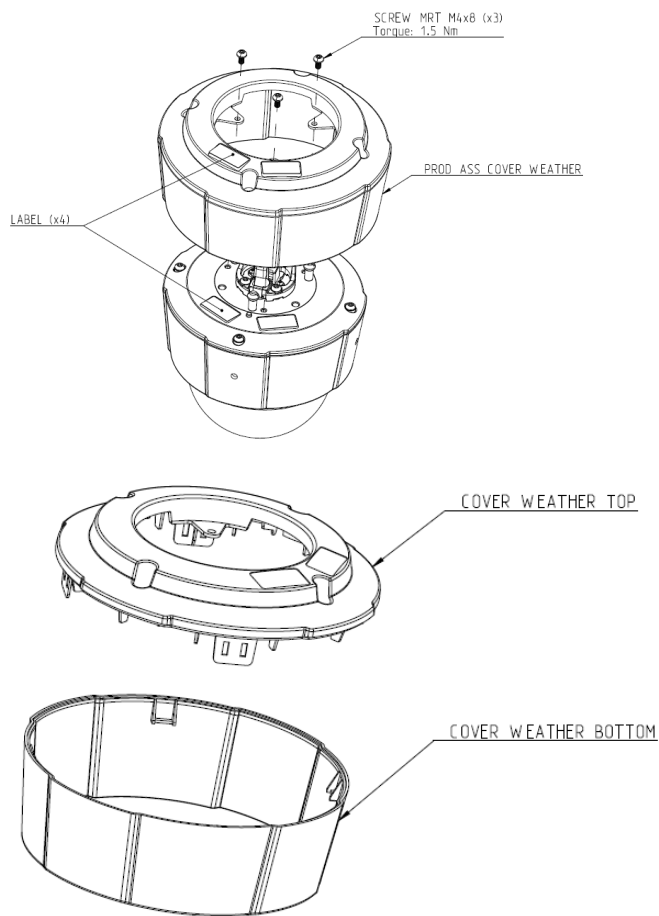

### 7.1.3 Dome Module Assembly

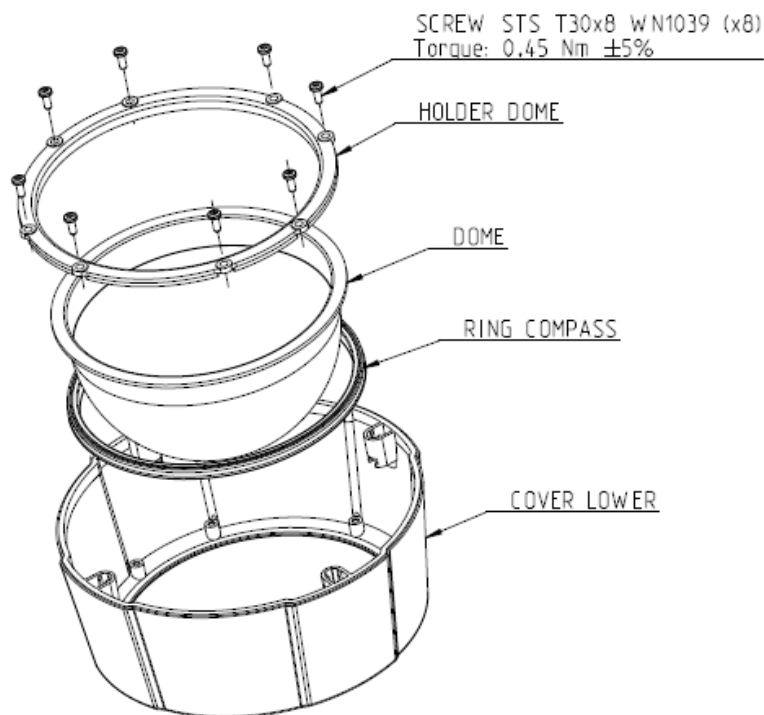

## 7.2 Assembly drawings of P551X series

### 7.2.1 Main Assembly

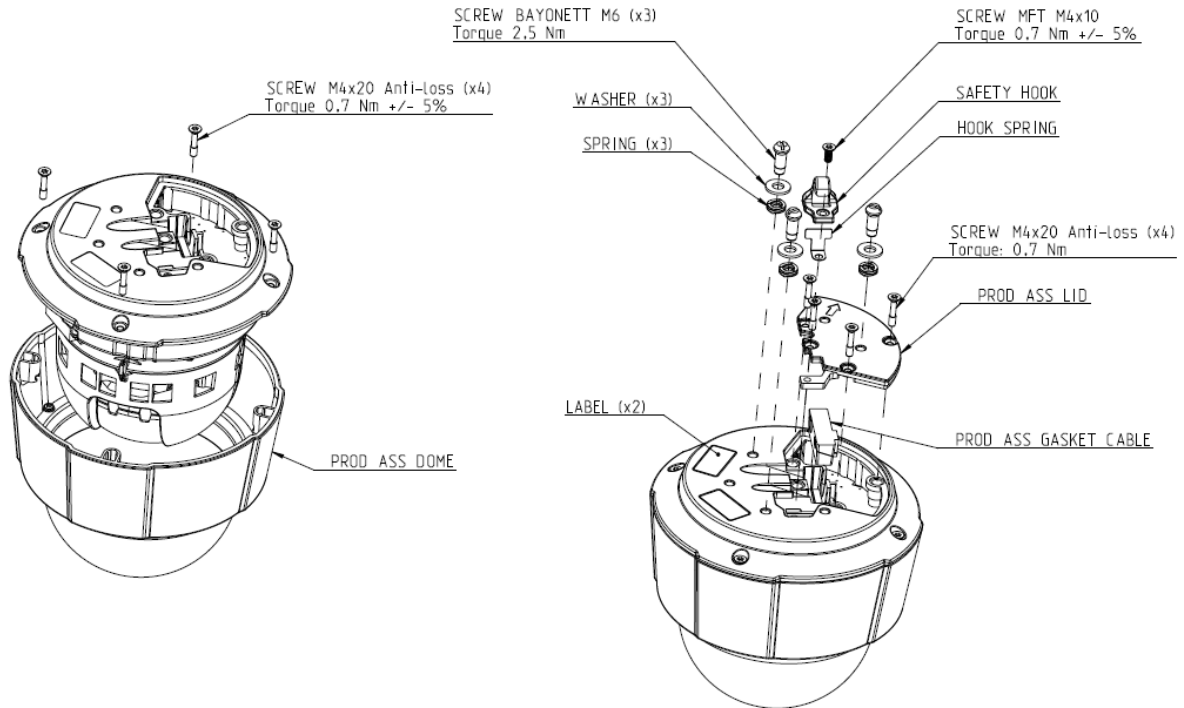

### 7.2.2 Dome Module Assembly

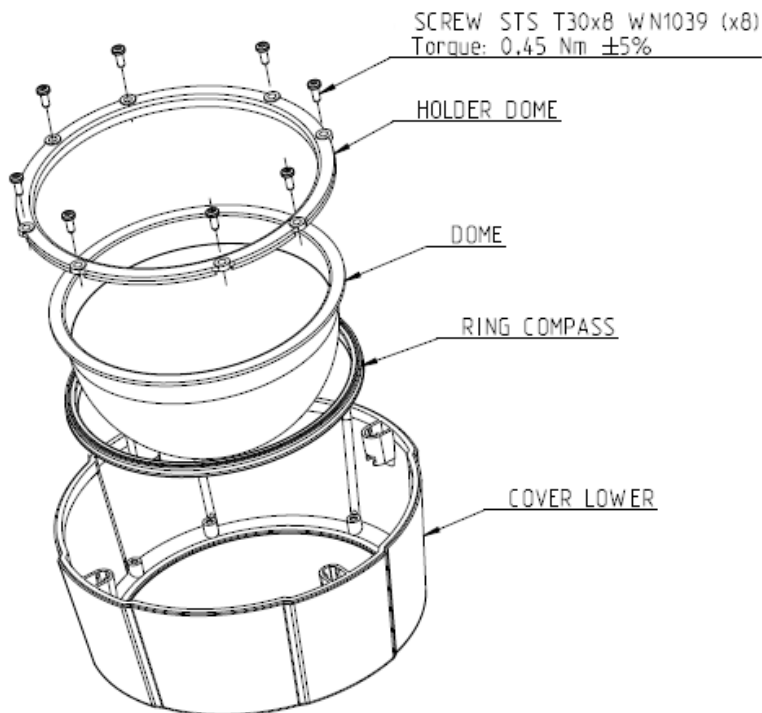

## 8 Revision History

REVISION	DATE	AUTHOR	DESCRIPTION
R1	April 7, 2016	Sven Svensson	First Revision
R2	April 7, 2016	Sven Svensson	Updated Table of content