



SAMCON
Prozessleittechnik GmbH



Assambly Instruction

product: PMB EXCAM XPT
author: S. Weber
date: June 12, 2018
doc ID: 180612-PZUQS-SW-PMB EXCAM XPT_assembly
instruction_rev.oo.idw



INTRO

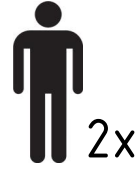

What you need:	
Wrench	19mm
Wrench	17mm
Torque wrench	17 - 19mm

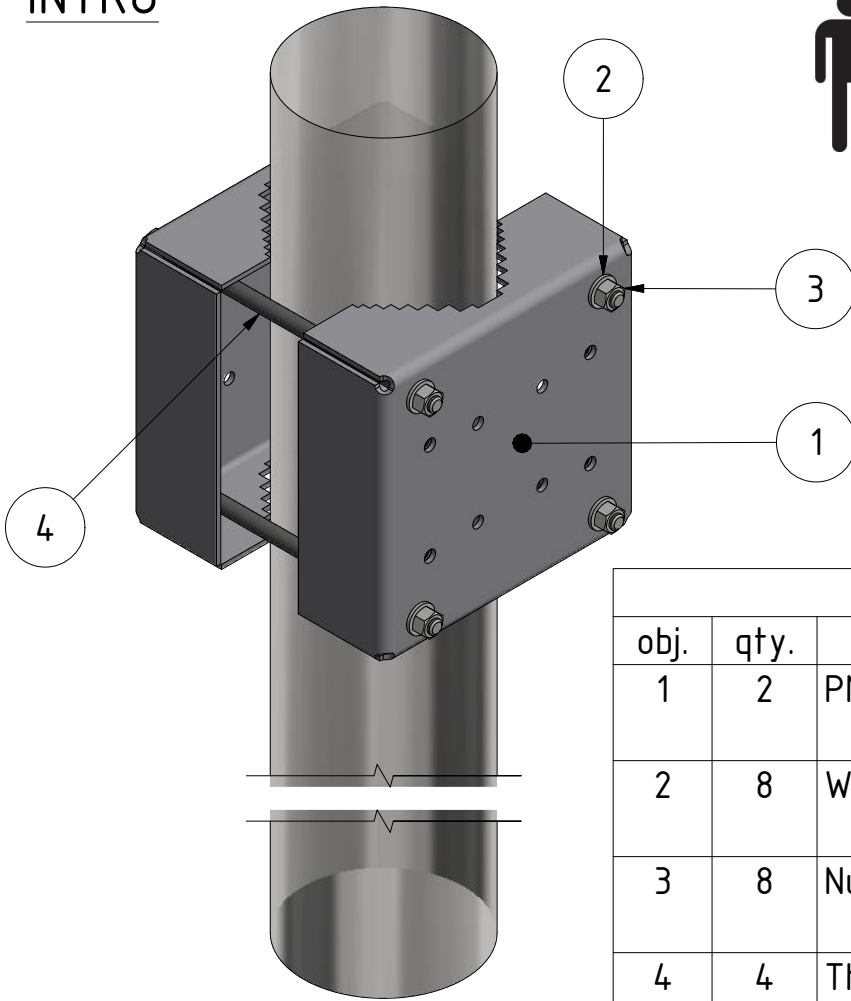

ATTENTION:

Please be careful when working at heights !



Table of content			
obj.	qty.	part	material
1	2	PMB EXCAM XPT	stainless steel
2	8	Washer DIN 125 - A 13	stainless steel
3	8	Nut ISO 4032 - M12	stainless steel
4	4	Threaded rod M12 x 1.5 x 260	stainless steel

1

*External equipment
Please mount first!*

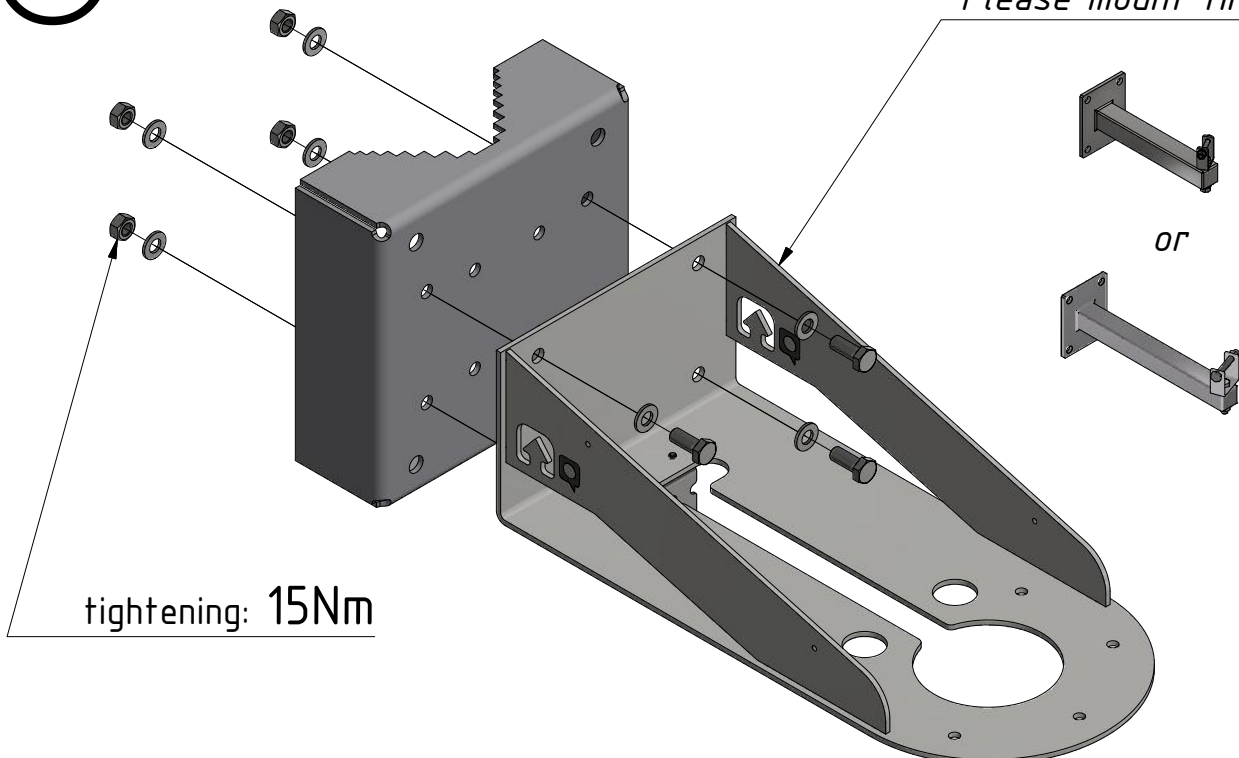

tightening: 15Nm

2

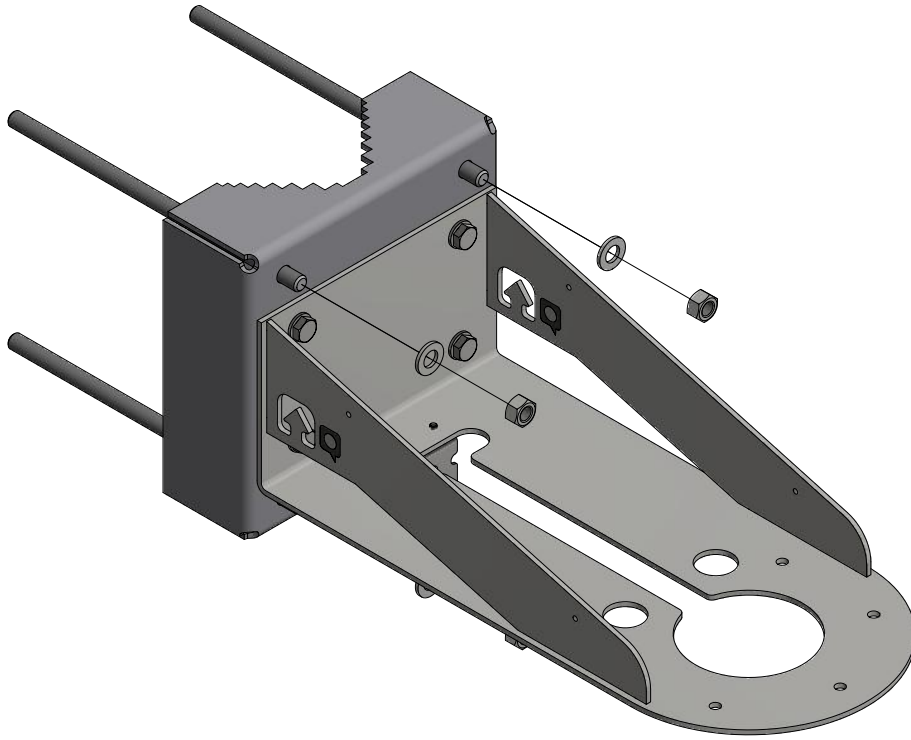

3

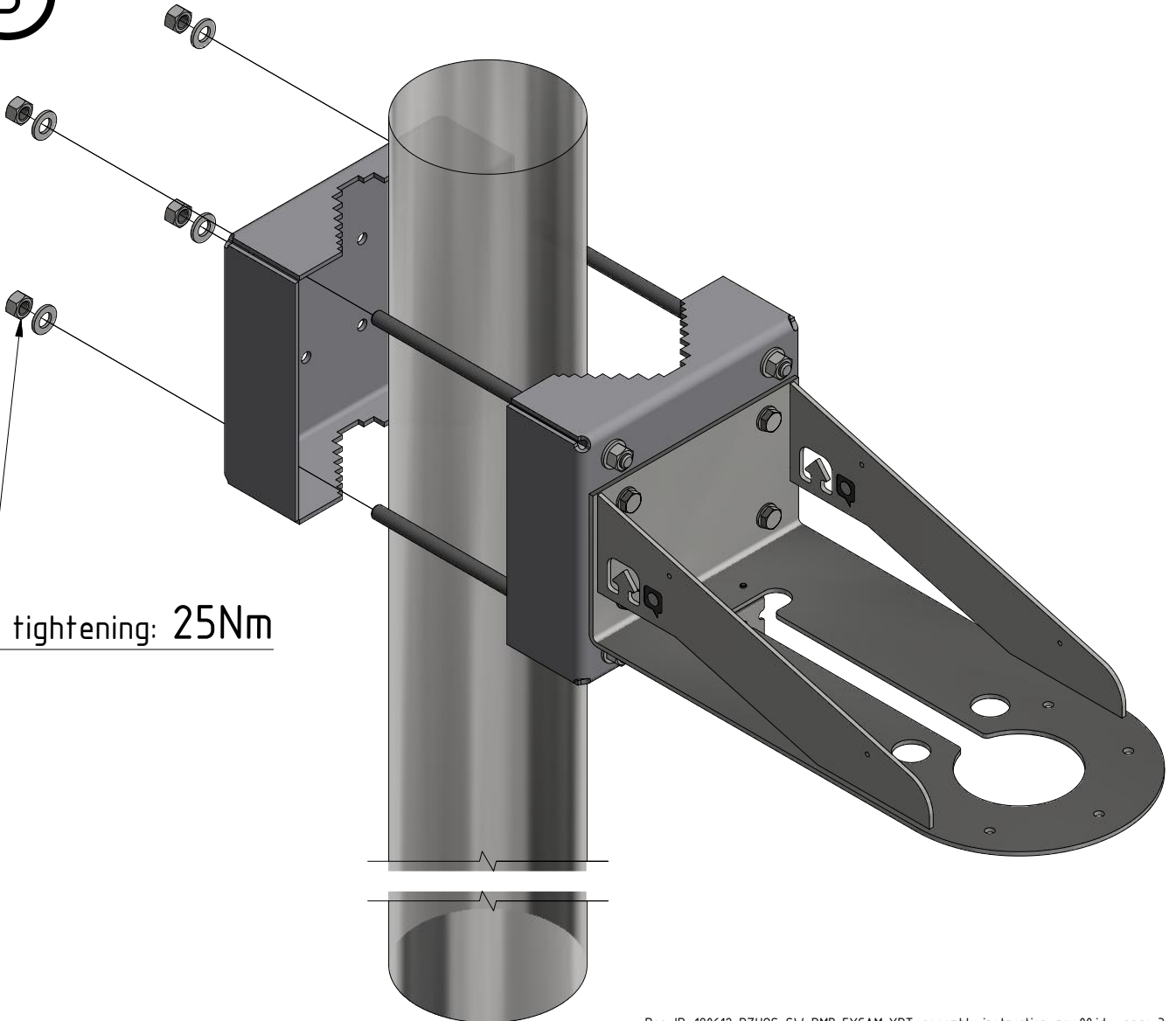

tightening: 25Nm

4



Note:
For more information see
other assembly instructions!