

AXIS W400 Body Worn Activation Kit

Ativação automática de câmeras de uso corporal

O AXIS W400 Body Worn Activation Kit ativa a gravação automaticamente por todas as câmeras de uso corporal no mesmo sistema quando uma barra de luz ou sirene é ativada ou um botão de pânico é pressionado. Isso ajuda a manter os departamentos de polícia em conformidade com as regulamentações, por exemplo. E também garante que haja sempre imagens de eventos agravados.

- > [Ativação automática da gravação](#)
- > [Acionamento por E/S](#)
- > [Uso de sinalizadores Bluetooth[®]](#)



AXIS W400 Body Worn Activation Kit

Geral

Conteúdo da embalagem	AXIS D3110 Connectivity Hub, LM842 WiFi 802.11ac / Bluetooth® 5.0 USB Combi Adapter, LM256 RP SMA Dual Band 2.4GHz and 5.8GHz Antenna, AXIS TD3901 Strain Relief Para obter as especificações completas, consulte a folha de dados do AXIS D3110 em axis.com/products/axis-d3110-connectivity-hub
Condições operacionais	-20 °C a 65 °C (-4 °F a 149 °F)
Condições de armazenamento	-40 °C a 65 °C (-40 °F a 149 °F) Umidade relativa de 5 - 90% (sem condensação)
Dimensões	Para obter as dimensões do produto, consulte os esquemas de dimensões nesta folha de dados.
Peso	AXIS D3110 Connectivity Hub: 392 g (0,9 lb) LM842 WiFi / Bluetooth® Adapter: 6 g (0,01 lb) LM256 Antenna: 10 g (0,02 lb) AXIS TD3901 Strain Relief: 35 g (0,08 lb)

Aprovações

AXIS D3110 Connectivity Hub:

EMC

CISPR 35, EN 50121-4, EN 50130-4, EN 61000-3-2, EN 61000-3-3, EN 61000-6-1, EN 61000-6-2, FCC Parte 15 Subparte B Classe A, IEC 62236-4, KC KN32 Classe A, KC KN35, RCM AS/NZS CISPR 32 Classe A, VCCI Classe A

Segurança

CAN/CSA C22.2 No. 62368-1, IEC/EN/UL 62368-1, UL 2043, UN ECE R118

Ambiente

IEC 60068-2-1, IEC 60068-2-2, IEC 60068-2-6, IEC 60068-2-14, IEC 60068-2-27, IEC 60068-2-64, IEC TR 60721-4-5 Class 5M3, IEC/EN 61373 Categoria 1 Classe B, NEMA TS 2 (2.2.7-2.2.9)

Rede

NIST SP500-267

Acessórios opcionais

AXIS Surveillance Cards

Para mais acessórios, acesse axis.com/products/axis-w400-body-worn-activation-kit/accessories

Garantia

Garantia de 3 anos, consulte axis.com/warranty

Números de peça

Disponível em axis.com/products/axis-w400-body-worn-activation-kit#part-numbers

Esquemas de dimensões

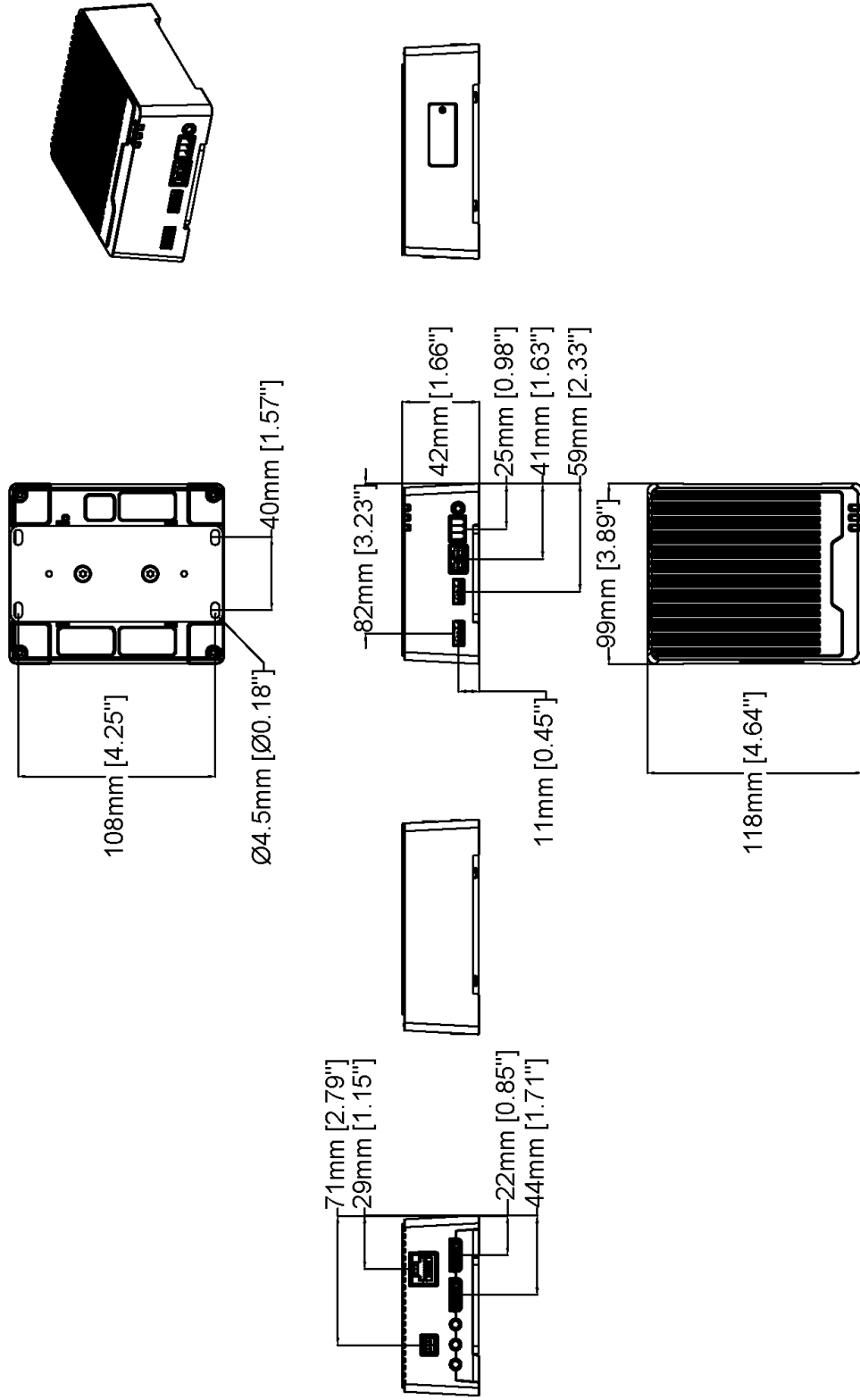

AXIS D3110 Connectivity Hub

Revision	v.01	Revision date	2021-05-31
Paper size	A4	Release date	2021-05-31
Created by	JSK	Scale	1:3

© 2021 Axis Communications

www.axis.com

12mm [0.47"]

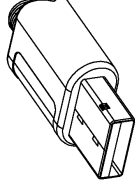
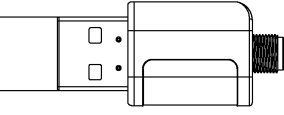

9mm [0.37"]

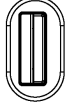
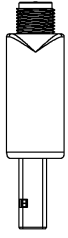
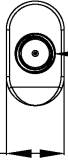

5mm [0.20"]

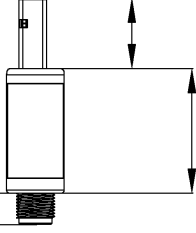

Ø6mm [Ø0.25"]

20mm [0.80"]

37mm [1.45"]

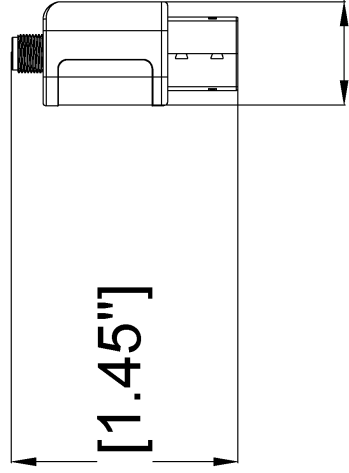

17mm [0.66"]



www.axis.com

LM842 WiFi 802.11ac / Bluetooth® 5.0 USB Combi Adapter

Revision	v.01	Revision date	2023-10-19
Paper size	A4	Release date	2023-10-19
Created by	MIF	Scale	1:1

© 2023 Axis Communications

Adjustable 360° Swivel
with 3 tilt options.

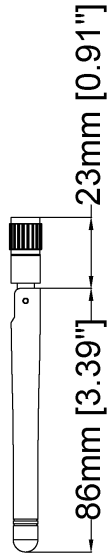
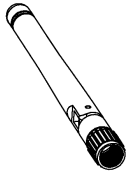
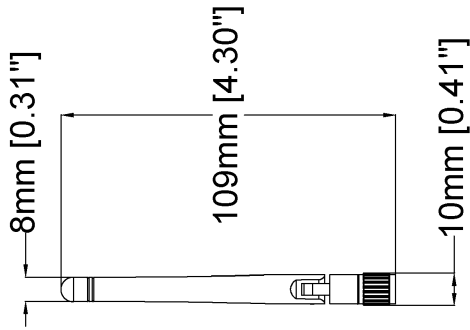
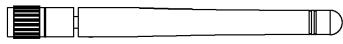
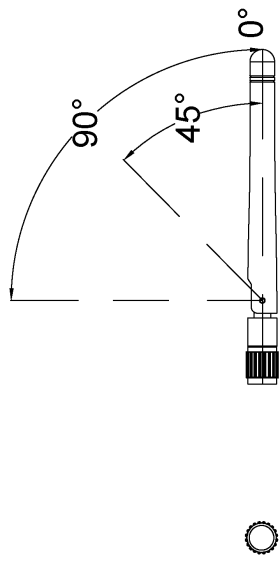

www.axis.com

LM256 RP SMA Dual Band 2.4GHz and 5.8GHz Antenna

Revision	v.01	Revision date	2023-10-13
Paper size	A4	Release date	2023-10-13
Created by	MF	Scale	1:2

© 2023 Axis Communications