

AXIS Q6318-LE PTZ Camera

Repainting Instructions

AXIS Q6318-LE PTZ Camera

Impact on warranty

Impact on warranty

This product is approved for repaint by Axis, provided that you follow the instructions in this document and at axis.com/warranty-implication-when-repainting.

Risks with repainting

There are several risks when disassembling or assembling an Axis product. There is always a certain yield loss during assembly. Training of operators and the use of correct tools mediates some of the problems but they can never be fully avoided. Some of the risks include:

ESD Damage – Always handle the product in an ESD safe environment. Even if precautions are taken there is always a risk of ESD damage. The damage can remain undetected and cause problems during the lifetime of the equipment.

Dust contamination – Opening a camera may expose the lens and sensor to dust or paint. Dust will affect the optical performance. Lenses need to be disassembled in a dust-free environment, preferably a cleanroom.

Paint overspray – Masking the different components of the equipment is critical. Failure to mask sensitive areas can cause problems with assembling the equipment. Any areas that are not painted at factory or have a different surface treatment than the rest of the parts (threads, ground and electrical contact surfaces) must also be masked to ensure function.

AXIS Q6318-LE PTZ Camera

Repaint the product

Repaint the product

Preparations

- If applicable, disassemble the device according to the instructions in this document.
- Clean all parts that will be repainted thoroughly to remove grease, dust, or oil.
- To ensure reassembly and functionality of the product, mask any openings (for example for screws, LED indicators, or microphones) before you paint.

Pretreatment of parts

Depending on the part material and type of paint applied at factory, different pretreatment should be done for the new paint to adhere as well as possible. Clean the parts properly to remove oil, grease and dust.

Powder coated parts – Use a primer. Alternatively, remove the original powder coating down to the base material, using fine sandpaper, and clean the parts before painting.

Anodised and chromated parts – Use a primer.

Uncoated stainless steel – No special pretreatment is needed, but make sure that the surface is clean before painting.

Plastic – Use a primer.

Material used in product

The material used in the product are:

- Chassis: Aluminium EN AC-43400
- Top of the weather shield : ASA Luran S 797SEUV
- Bottom of the weather shield: PA+GF Grilamid LV-3H(GF30)

AXIS Q6318-LE PTZ Camera

Repaint the product

Disassembly

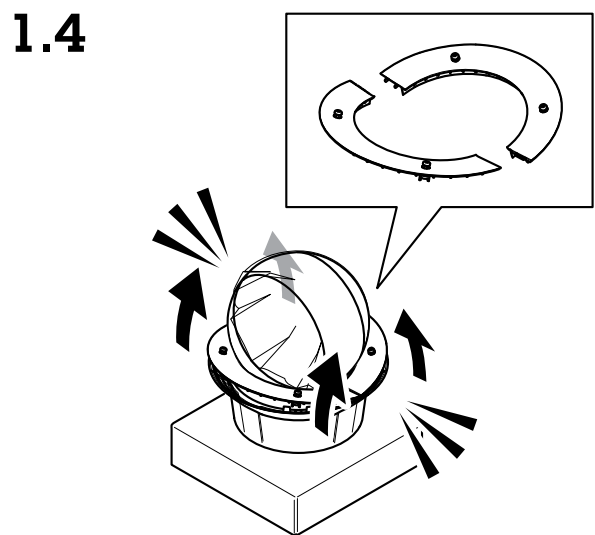
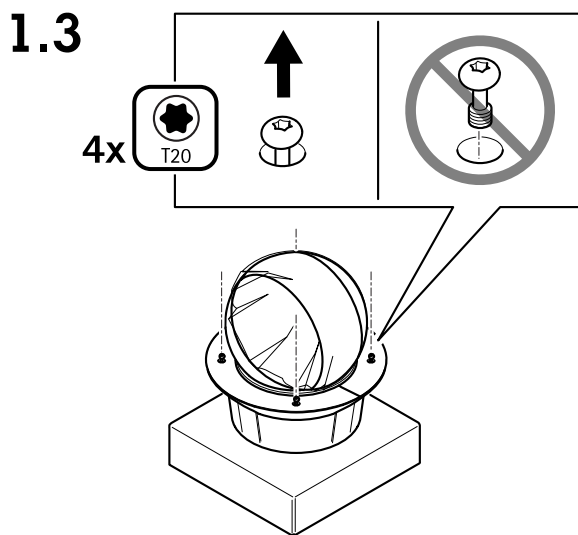
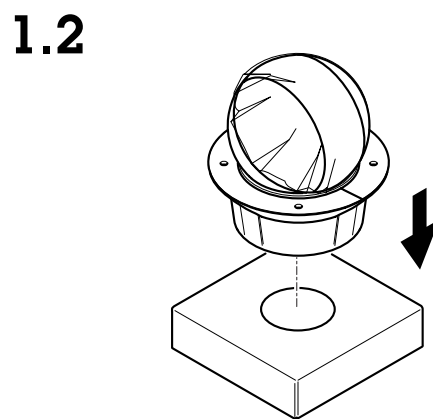
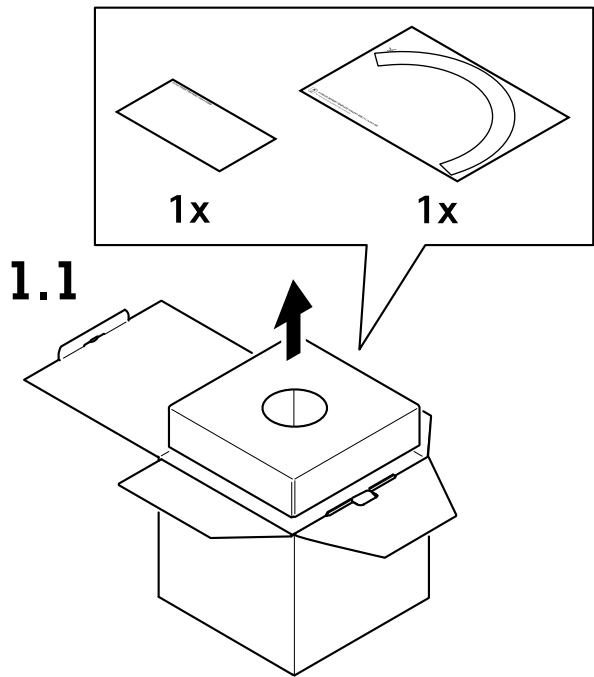

AXIS Q6318-LE PTZ Camera

Repaint the product

1.5

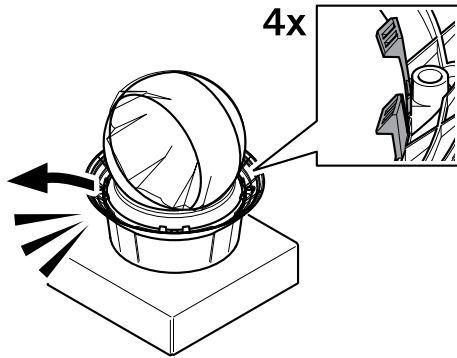

1.6

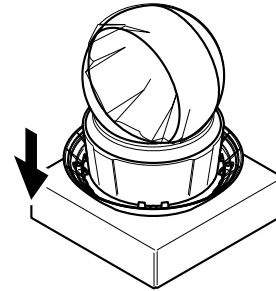

Repainting

2.1

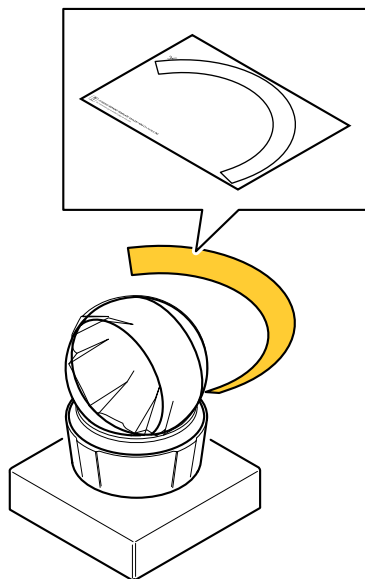

2.2

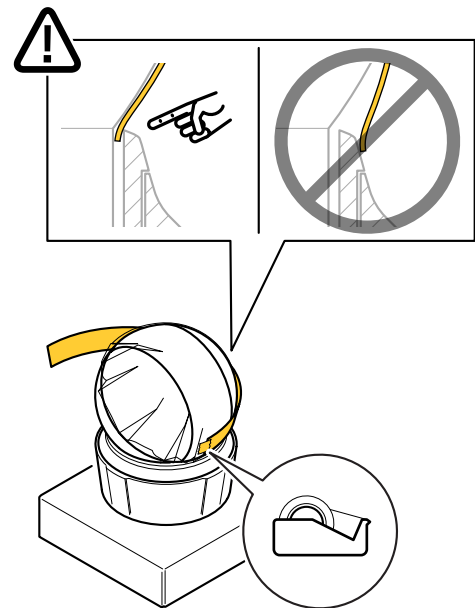

2.3

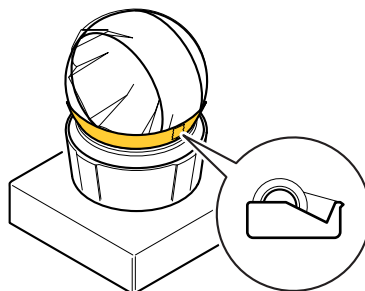

2.4

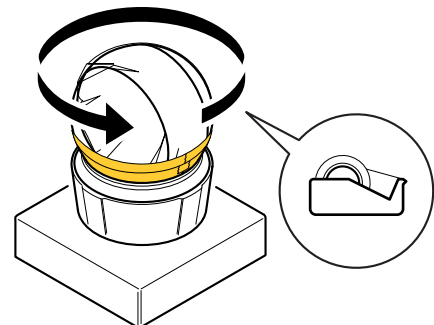

AXIS Q6318-LE PTZ Camera

Repaint the product

2.5

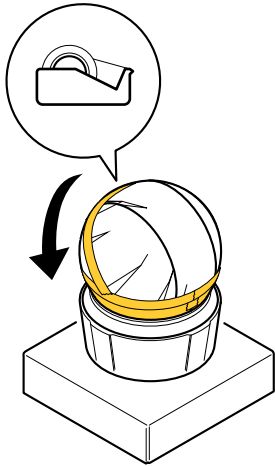

2.6

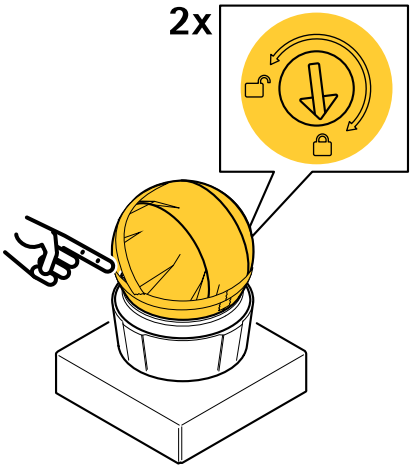

2.7

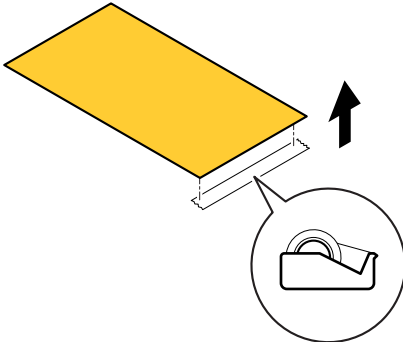

2.8

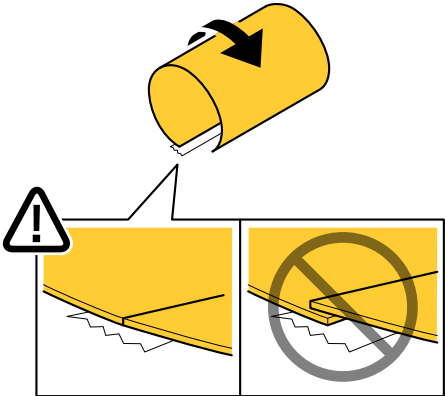

2.9

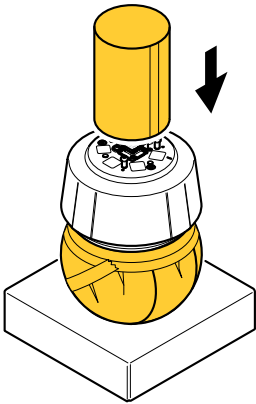

2.10

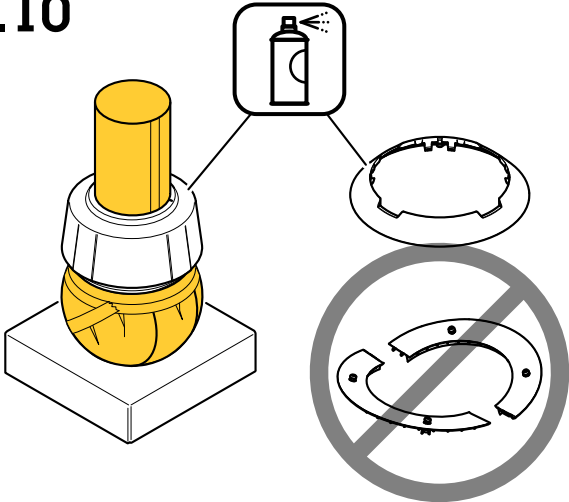

AXIS Q6318-LE PTZ Camera

Repaint the product

Reassembly

3.1

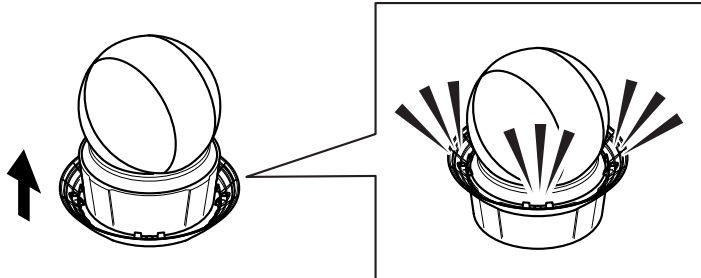

3.2

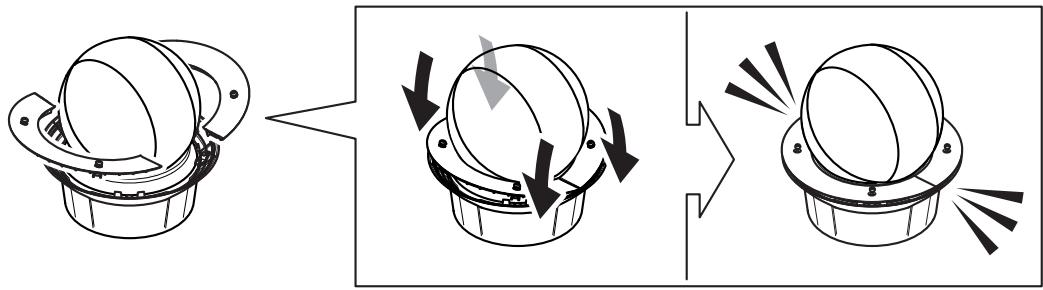

3.3

