

AXIS D6310 Air Quality Sensor

Advanced indoor environmental monitoring and alerts

Built on AXIS OS, this standalone, easy-to-integrate device lets you monitor indoor air quality. It can detect vaping and smoking, as well as measure various air pollutants, including particulate matter (PM) and carbon dioxide (CO₂). A virtual stream lets you view live data and visualize measurements in a dashboard. This advanced sensor includes a microphone, which can be disabled with a physical switch to ensure privacy is safeguarded. And AXIS Audio Analytics offers AI-based actionable insights. What's more, this vandal-resistant, IK08-rated device includes a PIR sensor for presence detection. Plus, a built-in speaker and four multicolored LEDs let you automate responses using audio and/or visual alerts.

- > [All-in-one standalone device](#)
- > [Detect vaping and smoking](#)
- > [Measure indoor air quality \(IAQ\)](#)
- > [Easy to integrate and access data](#)
- > [Visual alerts and two-way communication](#)



AXIS D6310 Air Quality Sensor

Sensors

Temperature

Range: -10 °C to 45 °C (14 °F to 113 °F)
Accuracy: ± 1 °C

Humidity

Range: 0 to 100 %RH
Accuracy: ± 6 %RH

Carbon dioxide (CO₂)

Range: 0 to 40000 ppm
Accuracy: 400 to 1000 ppm : ±(50 + 2.5 % m.v.¹) ppm,
1001 to 2000 ppm : ±(50 + 3 % m.v.¹) ppm.
2001 to 5000 ppm : ±(40 + 5 % m.v.¹) ppm.

Particle matter (PM1.0)

Range: 0 to 1000 µg/m³
Accuracy: 0 to 100 µg/m³ : ± 5 % m.v.¹
Accuracy: 101 to 1000 µg/m³ : ± 10 % m.v.¹

Particle matter (PM2.5)

Range: 0 to 1000 µg/m³
Accuracy: 0 to 100 µg/m³ : ± 5 % m.v.¹
Accuracy: 101 to 1000 µg/m³ : ± 10 % m.v.¹

Particle matter (PM4.0)

Range: 0 to 1000 µg/m³
Accuracy : ± 25 % m.v.¹

Particle matter (PM10.0)

Range: 0 to 1000 µg/m³
Accuracy : ± 25 % m.v.¹

Volatile organic compounds (VOC) index

Range: 0 to 500
Accuracy: ± 5 % m.v.¹

Air quality index (AQI)

Range: 0 to 500
Accuracy: ± 10 % m.v.¹

Nitric oxide and nitrogen dioxide (NO_x) index

Range: 0 to 500
Accuracy: ± 10 % m.v.¹

Humidex

Range: 0 °C to 96 °C (32 °F to 205 °F)
Accuracy: ± 0.7 °C (± 1.26 °F)

Heat index

Range: 0 °C to 153 °C (32 °F to 307 °F)
Accuracy: ± 0.7 °C (± 1.26 °F)

Sampling frequency

1 sample/second²

Storage frequency

High Frequency: 1 sample/second, up to 30 days
Balanced: 1 sample/5 seconds, up to 90 days
High Retention: 1 sample/10 seconds, up to 365 days

System on chip (SoC)

Model

S6L

Memory

1 GB RAM, 8 GB Flash

Video

Video compression

H.264 (MPEG-4 Part 10/AVC) Main and High Profiles
H.265 (MPEG-H Part 2/HEVC) Main Profile
Motion JPEG

Resolution

16:9: 1280x720

Frame rate

Up to 30 fps

Video streaming

Controllable frame rate

Audio hardware

Enclosure

1.8 inch dynamic cone speaker in sealed enclosure

Max sound pressure level

86 dB (at 1 m / 39.4 in) at 4.89 kHz

1. Of measured value

2. Applies to all the sensors in this product.

Frequency response

230 Hz - 13.3 kHz

Coverage pattern

150°

Input

Built-in microphone (can be disabled)

Physical microphone switch

Output

Built-in speaker

Built-in microphone specification

20 Hz - 20 kHz

Signal-to-noise ratio

72 dB

Amplifier description

Built-in 4 W Class D amplifier

Digital signal processing

Built-in and pre-configured

Audio management

AXIS Audio Manager Pro

Compatible with AXIS Audio Manager Pro 5.0 or later
For larger and more advanced systems. Sold separately.

See separate datasheet for specifications.

For specifications, see the datasheet on axis.com/products/axis-audio-manager-pro/support

Audio software

Streaming

Configurable duplex:

One-way (simplex, half duplex)

Two-way (half duplex, full duplex)

Encoding

24bit LPCM, AAC-LC 8/16/32/44.1/48 kHz, G.711 PCM

8 kHz, G.726 ADPCM 8 kHz, Opus 8/16/48 kHz

Configurable bitrate

Features

10-band graphic equalizer for audio input

Voice enhancer

Echo cancellation

Light

Illumination LED

Multi color status LED (red, yellow, green, and blue)

Network

Network protocols

IPv4, IPv6 USGv6, HTTP, HTTPS³, HTTP/2, TLS³, QoS Layer 3 DiffServ, FTP, SFTP, CIFS/SMB, SMTP, mDNS (Bonjour), UPnP[®], SNMP v1/v2c/v3 (MIB-II), DNS/DNSv6, DDNS, NTP, PTP, NTS, RTSP, RTP, RTSPS, TCP, RTCP, DHCPv4/v6, SSH, CDP, MQTT v3.1.1, Secure syslog (RFC 3164/5424, UDP/TCP/TLS), Link-Local address (ZeroConf)

System integration

Application Programming Interface

Open API for software integration, including VAPIX[®], metadata and AXIS Camera Application Platform (ACAP); specifications at axis.com/developer-community.

One-click cloud connection

ONVIF[®] Profile G and ONVIF[®] Profile S, specifications at onvif.org

Support for Voice over IP (VoIP) through the Session Initiation Protocol (SIP), using peer-to-peer (P2P) or Private Branch Exchange (PBX).

Modbus server over IP: Modbus TCP protocol and Ethernet on switch port mode.

Video management systems

Compatible with AXIS Camera Station Edge, AXIS Camera Station Pro, AXIS Camera Station 5, and video management software from Axis' partners available at axis.com/vms.

Onscreen controls

Media clip

Edge-to-edge

Speaker pairing

3. This product includes software developed by the OpenSSL Project for use in the OpenSSL Toolkit. (openssl.org), and cryptographic software written by Eric Young (eay@cryptsoft.com).

Event conditions

Air quality monitor: Air quality outside acceptable range, vaping or smoking detected
Audio: audio clip playing, physical microphone switch
Audio analytics: audio level above threshold, glass break detected, scream detected, shout detected, speech detected, SPL: above threshold upper, SPL: below threshold lower
Call: state, state change
Device status: above/below/within operating temperature, casing open, IP address blocked/removed, live stream active, network lost, new IP address, PIR sensor, system ready
Edge storage: storage disruption, storage health issues detected
I/O: digital input is active, digital output is active, manual trigger, virtual input is active
MQTT: MQTT client connected
Scheduled and recurring: schedule

Event actions

Audio clips: play, stop
Call: answer call, end call, make call
I/O: toggle I/O once, toggle I/O while the rule is active
LEDs: flash status LED, flash status LED while the rule is active
Light and siren: run light and siren profile, run light and siren profile while the rule is active, stop activities
MQTT: send MQTT publish message
Notification: HTTP, HTTPS, TCP and email
Recordings: record video, record video while the rule is active
Security: erase configuration
SNMP trap messages: send, send while the rule is active
Images or video clips: FTP, SFTP, HTTP, HTTPS, network share and email

Built-in installation aids

Pixel counter, level grid

Analytics

Applications

Included

AXIS Audio Analytics

Supported

Support for AXIS Camera Application Platform enabling installation of third-party applications, see axis.com/acap

AXIS Audio Analytics

Features: adaptive audio detection, audio classification, sound pressure level

Audio classes: scream, shout, glass break, speech

Event metadata: audio detections, classifications, sound pressure level

Approvals

Product markings

UL, CE, KC, VCCI, RCM

Supply chain

TAA compliant

EMC

CISPR 32 Class A, EN 55035, EN 55032 Class A, EN 61000-6-1, EN 61000-6-2
Australia/New Zealand: RCM AS/NZS CISPR 32 Class A
Canada: ICES(A)/NMB(A)
Japan: VCCI Class A
Korea: KS C 9835, KS C 9832 Class A
USA: FCC Part 15 Subpart B Class A

Safety

CAN/CSA C22.2 No. 62368-1 ed. 3, IEC/EN/UL 62368-1 ed. 3, IEC/EN 60825-1 Class 1

Environment

IEC 60068-2-1, IEC 60068-2-2, IEC 60068-2-6, IEC 60068-2-14, IEC 60068-2-27, IEC 60068-2-78, IEC/EN 62262 IK08

Network

IPv6 USGv6, NIST SP500-267

Cybersecurity

ETSI EN 303 645, BSI IT Security Label, FIPS 140

Cybersecurity

Edge security

Software: Signed OS, brute force delay protection, digest authentication, password protection, Axis Cryptographic Module (FIPS 140-2 level 1)
Hardware: Axis Edge Vault cybersecurity platform
Secure keystore: secure element (CC EAL 6+, FIPS 140-3 Level 3), system-on-chip security (TEE)
Axis device IDsecure boot, encrypted filesystem (AES-XTS-Plain64 256bit)

Network security

IEEE 802.1X (EAP-TLS, PEAP-MSCHAPv2)⁴, IEEE 802.1AE (MACsec PSK/EAP-TLS), IEEE 802.1AR, HTTPS/HSTS⁴, Network Time Security (NTS), host-based firewall

4. This product includes software developed by the OpenSSL Project for use in the OpenSSL Toolkit. (openssl.org), and cryptographic software written by Eric Young (ey@cryptsoft.com).

Documentation

AXIS OS Hardening Guide

Axis Vulnerability Management Policy

Axis Security Development Model

AXIS OS Software Bill of Material (SBOM)

To download documents, go to axis.com/support/cybersecurity/resources

To read more about Axis cybersecurity support, go to axis.com/cybersecurity

General

Casing

Aluminum and plastic casing

Color: white NCS S 1002-B

Mounting

Mounting bracket with junction box holes (double-gang, single-gang, 4" square, and 4" octagon)

Power

Power over Ethernet (PoE) IEEE 802.3af/802.3at Type 1 Class 3 or IEEE 802.3at Type 2 Class 4

Typical power consumption: 2.8 W

Max power consumption: 6.9 W

I/O functionality

1 digital/supervised input and 1 output 12 VDC output, max load 25 mA

Connectors

I/O: 4-pin 2.5 mm terminal block

Network: Shielded RJ45 10BASE-T/100BASE-TX/1000BASE-T PoE

Serial communication: RS485/RS422, 1 pcs, 4 pos, full duplex, terminal block

PIR sensor

Passive infrared (PIR) motion sensor

Max range: 5 m (16.4 ft)

Operating conditions

Temperature: -10 °C to 45 °C (14 °F to 113 °F)

Humidity: 0-90% RH (non-condensing)

Storage conditions

Temperature: -40 °C to 65 °C (-40 °F to 149 °F)

Humidity: 0-80% RH (non-condensing)

Dimensions

For the overall product dimensions, see the dimension drawing in this datasheet.

Weight

830 g (1.8 lb)

Box content

Air quality sensor, installation guide, terminal block connectors, owner authentication key

System tools

AXIS Site Designer, AXIS Device Manager

Available at axis.com

Languages

English, German, French, Spanish, Italian, Russian, Simplified Chinese, Japanese, Korean, Portuguese, Polish, Traditional Chinese, Dutch, Czech, Swedish, Finnish, Turkish, Thai, Vietnamese

Warranty

5-year warranty, see axis.com/warranty

Part numbers

Available at axis.com/products/axis-d6310-air-quality-sensor#part-numbers

Optional accessories

Mounting

AXIS T94K01D Pendant Kit, AXIS TP3101 Pendant Wall Mount

Sustainability

Substance control

RoHS in accordance with EU RoHS Directive 2011/65/EU and 2015/863, and standard EN IEC 63000:2018 REACH in accordance with (EC) No 1907/2006. For SCIP UUID, see echa.europa.eu

Materials

Renewable carbon-based plastic content: 65% (recycled)

To read more about sustainability at Axis, go to axis.com/about-axis/sustainability

Environmental responsibility

axis.com/environmental-responsibility

Axis Communications is a signatory of the UN Global Compact, read more at unglobalcompact.org

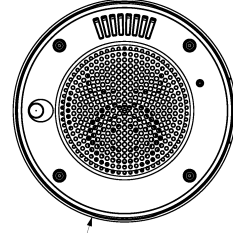
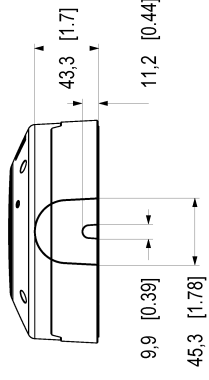
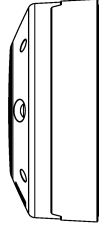
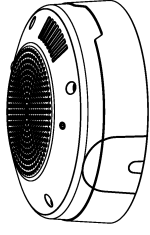
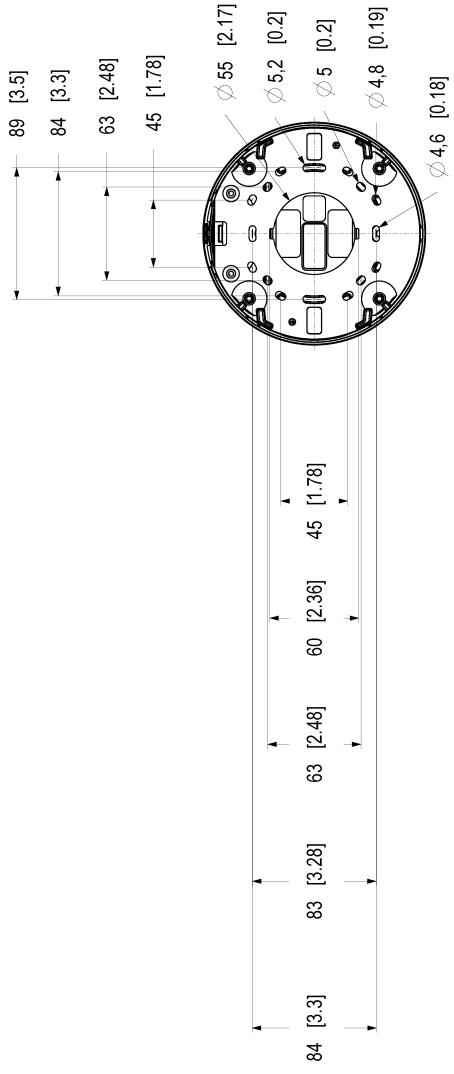

Dimensions in mm [inch]	
Case	100
Case Height	12
Case Width	100
Case Depth	100
Case Weight	100
Case Material	100
Case Color	100
Case Part No.	100

AXIS D6310 Air Quality Sensor

