

## **AXIS C1610-VE Network Sound Projector**

### **Repainting Instructions**

# AXIS C1610-VE Network Sound Projector

## Impact on warranty

---

### Impact on warranty

This product is not approved for repaint by Axis. If you still want to repaint the product, follow the instructions in this document and at [www.axis.com/warranty-implication-when-repainting](http://www.axis.com/warranty-implication-when-repainting)

### Risks with repainting

There are several risks when disassembling or assembling an Axis product. There is always a certain yield loss during assembly. Training of operators and the use of correct tools mediates some of the problems but they can never be fully avoided. Some of the risks include:

**ESD Damage** – Always handle the product in an ESD safe environment. Even if precautions are taken there is always a risk of ESD damage. The damage can remain undetected and cause problems during the lifetime of the equipment.

**Paint overspray** – Masking the different components of the equipment is critical. Failure to mask sensitive areas can cause problems with assembling the equipment. Any areas that are not painted at factory or have a different surface treatment than the rest of the parts (threads, ground and electrical contact surfaces) must also be masked to ensure function.

# AXIS C1610-VE Network Sound Projector

## Repaint the product

---

### Repaint the product

#### Preparations

- If applicable, disassemble the device according to the instructions in this document.
- Clean all parts that will be repainted thoroughly to remove grease, dust, or oil.
- To ensure reassembly and functionality of the product, mask any openings (for example for screws, LED indicators, or microphones) before you paint.

#### Pretreatment of parts

Depending on the part material and type of paint applied at factory, different pretreatment should be done for the new paint to adhere as well as possible. Clean the parts properly to remove oil, grease and dust.

**Powder coated parts** – Use a primer. Alternatively, remove the original powder coating down to the base material, using fine sandpaper, and clean the parts before painting.

**Anodised and chromated parts** – Use a primer.

**Uncoated stainless steel** – No special pretreatment is needed, but make sure that the surface is clean before painting.

**Plastic** – Use a primer.

# AXIS C1610-VE Network Sound Projector

## Repaint the product

---

### Disassembly

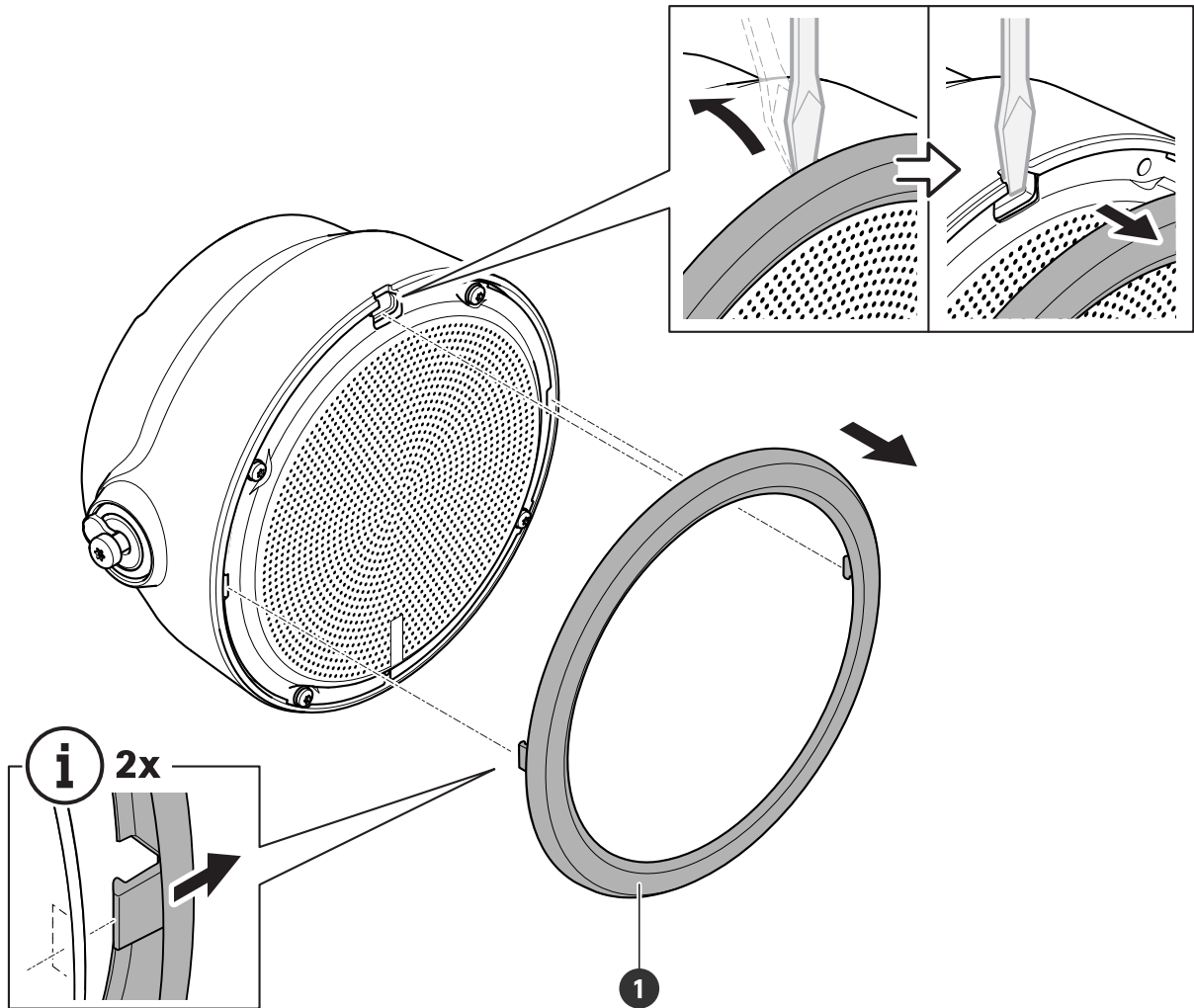

1. Remove the ring (1).

# AXIS C1610-VE Network Sound Projector

## Repaint the product

---

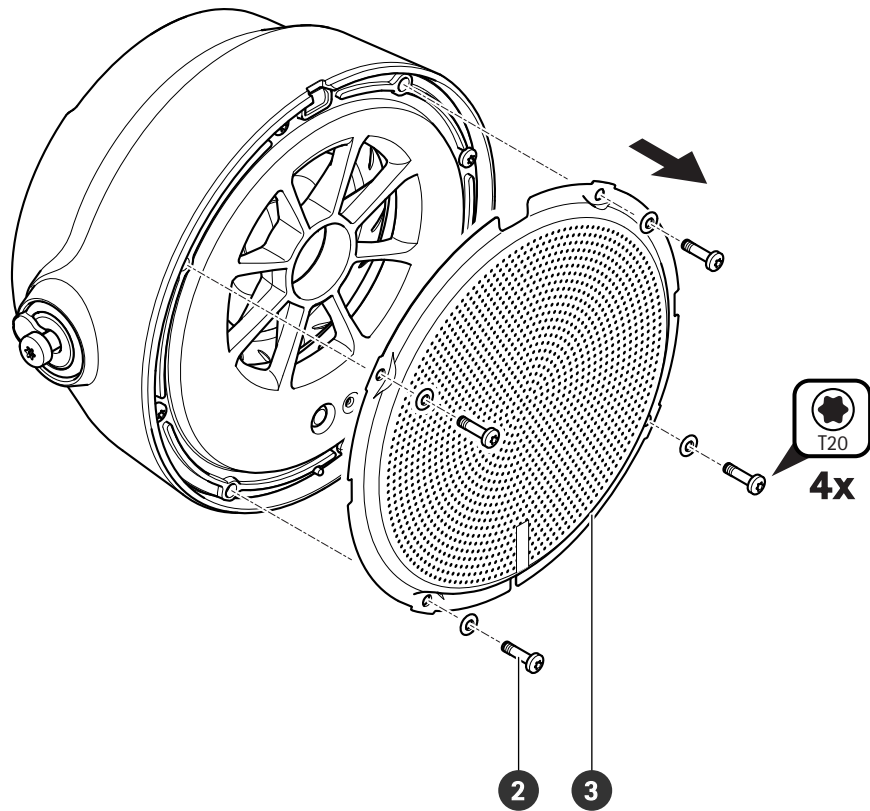

2. Remove the four screws (2).
3. Remove the mesh (3).

# AXIS C1610-VE Network Sound Projector

## Repaint the product

---

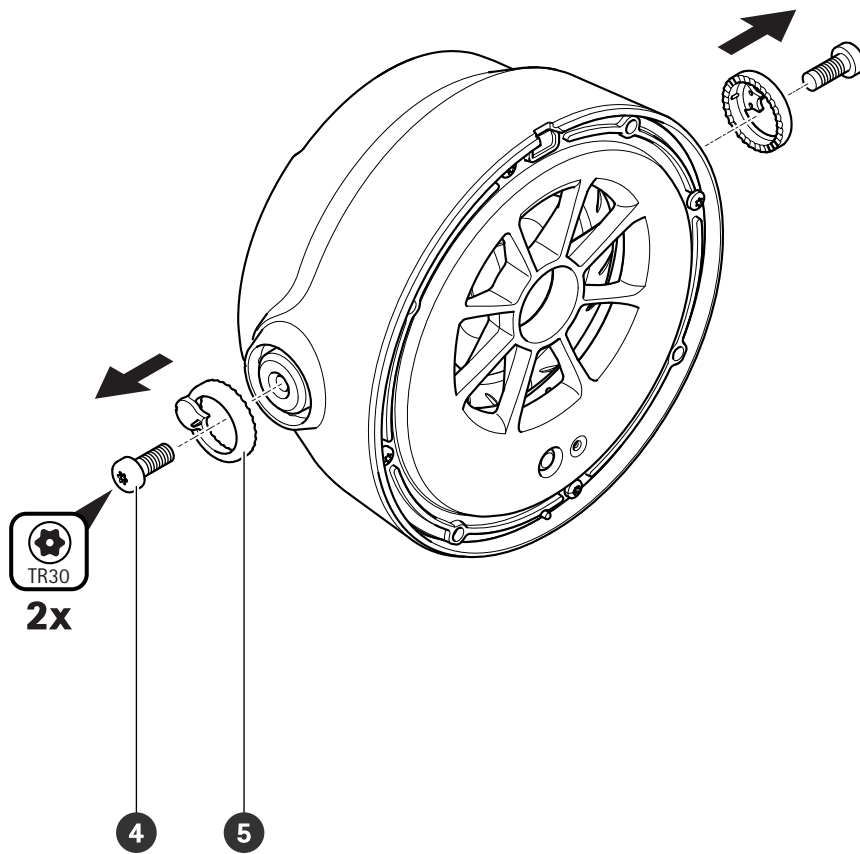

4. Remove the screws (4) and rings (5).

# AXIS C1610-VE Network Sound Projector

## Repaint the product

---

### Repainting

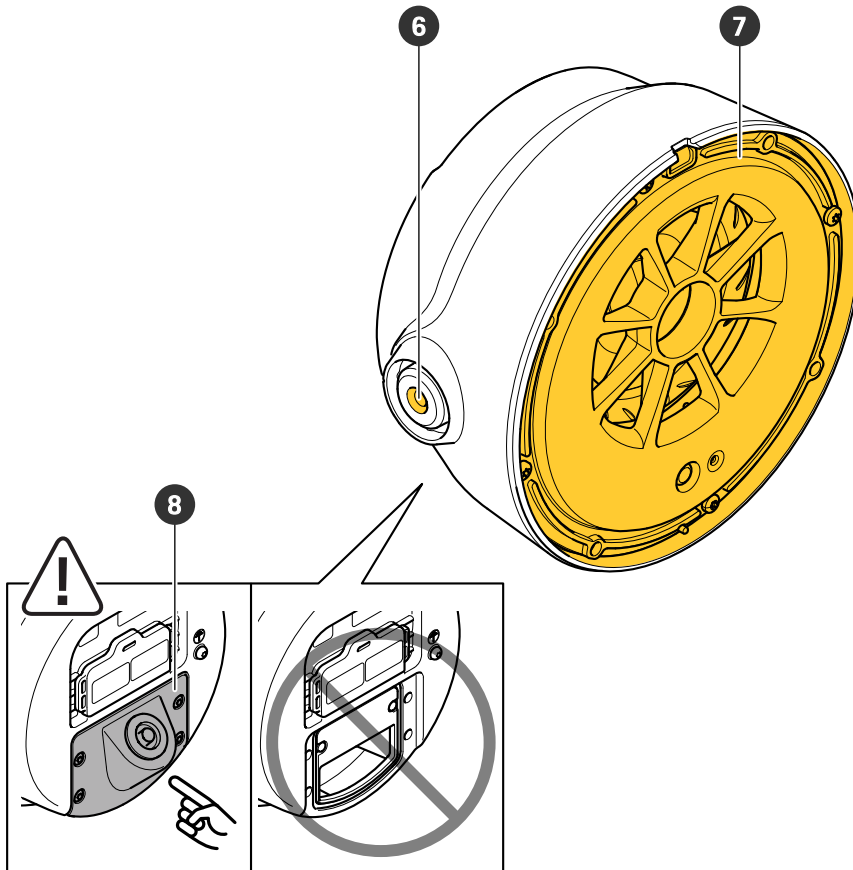

1. Cover the screw holes on the sides (6) and the front (7).
2. Make sure the back cover (8) attached.

# AXIS C1610-VE Network Sound Projector

## Repaint the product

---

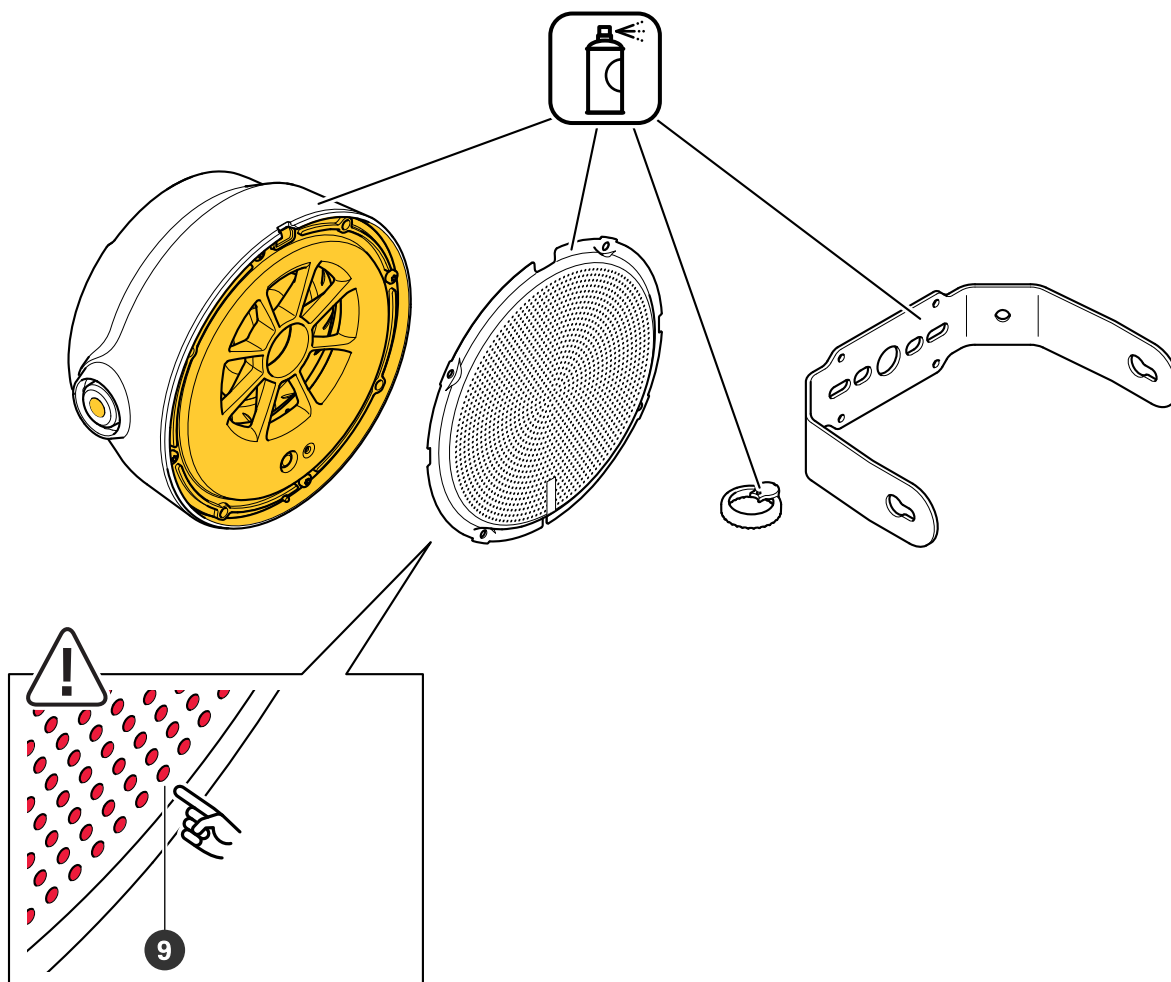

3. Make sure all necessary preparations of the cover have been made, see *Preparations on page 3*.
4. Apply a thin and even layer of spray paint according to the instructions of the paint manufacturer.

### **CAUTION**

Make sure the paint does not clog the mesh holes (9).

5. Let the paint dry.
6. To get a better coverage and clearer color, apply a second layer of spray paint.



# AXIS C1610-VE Network Sound Projector

## Repaint the product

---

### Reassembly

1. When the paint is dry, reassemble the product.

